



Henderson County Soil & Water Conservation District

61 Triple Springs Rd

Hendersonville, North Carolina 28792

Memorandum To: Potential Bidders

From: Betsy Gerwig
Conservation Engineer

Subject: Addendum 1: Request for Proposals Rugby Middle School – Stream Stabilization Project

Date: 1/24/2023

This addendum forms a part of and modifies the bidding requirements, contract forms, contract conditions, and/or the specifications for the Request for Proposals: Rugby Middle School – Stream Stabilization Project. Bidder shall acknowledge receipt of the Addendum by signature and date below. The signed addendum shall be submitted as a part of your proposal. Failure to do so may subject the Bidder to **disqualification**.

The following clarifications, modifications and additions are to be made to the scope of work:

1. Sewer Line Information:
 - a. Material: 8-inch PVC pipe
 - b. Timber matting should be used to spread the load of equipment across the width of MSD's easement. Matting shall be installed at all proposed pipe crossing locations.
 - c. Easement is 20 feet. (i.e., 10ft either side of sewer line)
 - d. No excavation or fill within easement area.
2. Excavated Soil Stockpiles:
 - a. In the floodplain on right bank (east), approximately 960 cubic yards of excavated soil can be deposited. An area of 0.8 acres with a depth of 0.75 feet (9 inches) can be utilized within the floodplain. Area will be noted with flags prior to construction. Area should be graded flat to sloped area and seeded.
 - b. Outside the floodplain on left bank (west), approximately 300 cubic yards of excavated soil can be deposited. An area of 0.73 acres with a depth of 0.25 feet (3 inches) can be utilized within the floodplain. Area will be noted with flags prior to construction. Area should be graded flat to sloped area and seeded.
 - c. Outside the floodplain on left bank (east), the remaining excavated soil can be deposited on the raised areas along Hwy 191. Place on the pad furthest from the school entrance. Silt fence should be placed around pile.

- d. Total soil to be excavated is 1,600 cubic feet, with approximately 600 cubic yards on right side (east) and 1,000 cubic yards on right side (west). Drawing is attached. Locations for mulch stockpiles are also shown on drawing.

Signature: _____

Date: _____

**PROPOSED
Elevation Intervals**

- 5 ft
 - - - 1 ft
- Elevation Assumed.

Total estimated soil removal = ~1,600 cuyd
 Land Applied in Floodplain = ~960 cuyd
 Land Applied, West side, Not in Floodplain = ~300 cuyd
 Stockpiled on elevated pad = ~400 cuyd

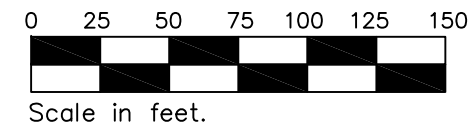
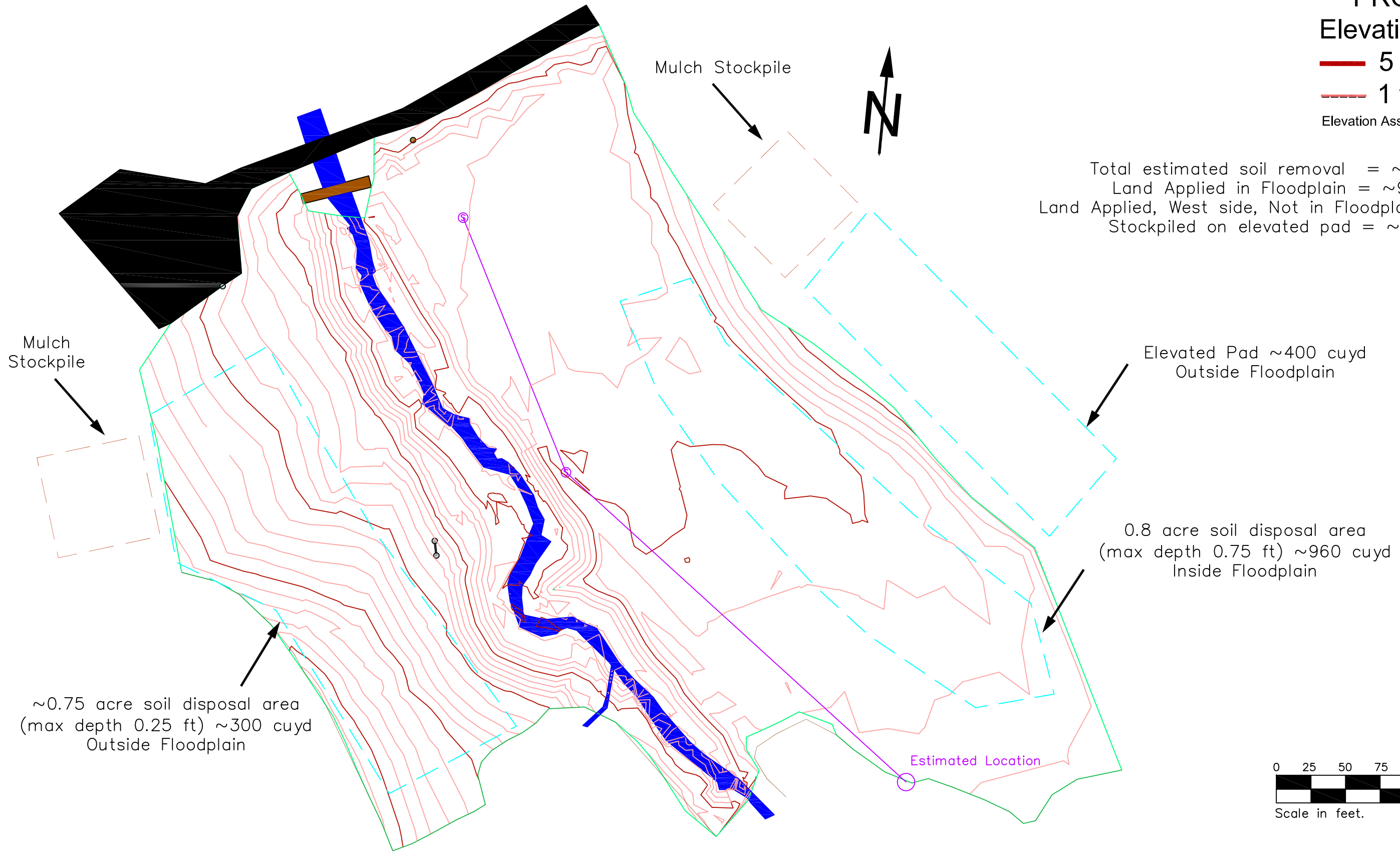

HENDERSON COUNTY
 SOIL AND WATER
 CONSERVATION DISTRICT
 61 TRIPLE SPRINGS ROAD, HENDERSONVILLE, NC 28792
 (828) 697-4949

RUGBY MIDDLE SCHOOL
 MILL POND CREEK RESTORATION – UPPER SECTION
 HENDERSON COUNTY
 35.357821, -82.512278

PROJECT #: MRP-2021-105	SCALE: 1 inch = 20 feet
DRAWN BY: Betsy K Gerwig	DATE: November 21, 2022
CHECKED BY:	DATE:
SHEET: SOIL	FILENAME: Rugby-Stream_6-2022rec_uBedits2.dwg