

# HCPS ENTRANCE SECURITY RENOVATIONS

MARK LUSK ARCHITECTURE PLLC  
128 WOODBURN DR  
SWANNANOVA, NC 28778  
828.808.9757  
MLARCHITECTURE@CHARTER.NET

## HENDERSON COUNTY CONSOLIDATED SCHOOLS

### Owner Representative

MARTIN BALLARD  
HENDERSON COUNTY PUBLIC SCHOOLS  
246 EDUCATION DRIVE  
FLAT ROCK, NC 28731

KENT PARENT  
HENDERSON COUNTY PUBLIC SCHOOLS  
246 EDUCATION DRIVE  
FLAT ROCK, NC 28731

### Architect

MARK LUSK ARCHITECTURE PLLC  
128 WOODBURN DRIVE  
SWANNANOVA, NC 28778  
828.808.9757

LIST OF DRAWINGS	
T101	COVER SHEET
ARCHITECTURAL	
A201	FLOOR PLANS
A202	FLOOR PLAN

### THE FOLLOWING HENDERSON COUNTY SCHOOLS ARE INCLUDED IN THIS PROJECT

- WEST HENDERSON HIGH
- DANA ELEMENTARY
- MARLOW ELEMENTARY
- ETOWAH ELEMENTARY

THE WORK CONSISTS OF DOORS, WALLS, WINDOWS, AND HARDWARE TO CONTAIN ENTRY FOR VERIFICATION AND SECURITY MEASURES. REQUIRED MEANS OF EGRESS IS MAINTAINED.

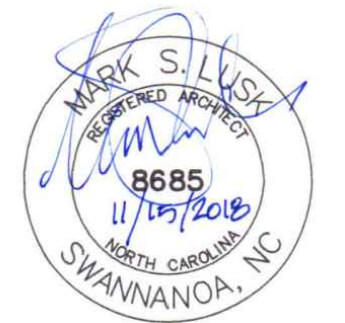

### HCPS ENTRANCE SECURITY RENOVATIONS

Project Number: \_\_\_\_\_  
Checked: \_\_\_\_\_  
Drawn: A. Rognas  
Date: 11/15/18

### Cover Sheet

T101

© Copyright 2018. All Rights Reserved. Reproduction, copying or use of this drawing and design shown herein without written consent of Mark Lusk Architecture PLLC is prohibited and any infringement is subject to legal action.

**CONSTRUCTION NOTES**

- ① EXISTING ENTRY DOORS: HARDWARE SHALL REMAIN.
- ② EXISTING VESTIBULE DOORS: HARDWARE SHALL REMAIN.
- ③ EXISTING LOBBY DOOR: HARDWARE SHALL REMAIN.
- ④ EXIT DOOR: PROVIDE ELECTRIC STRIKE WITH CONTROLLER AT DESK, PROVIDE LOCKSET W/ CLASSROOM INTRUDER FUNCTION, CLOSER, HINGES, KICKPLATE.
- ⑤ FOYER DOORS: PROVIDE PANIC DEVICES, PULLS, VERTICAL RODS, HOLD OPEN CLOSERS, KICKPLATES.

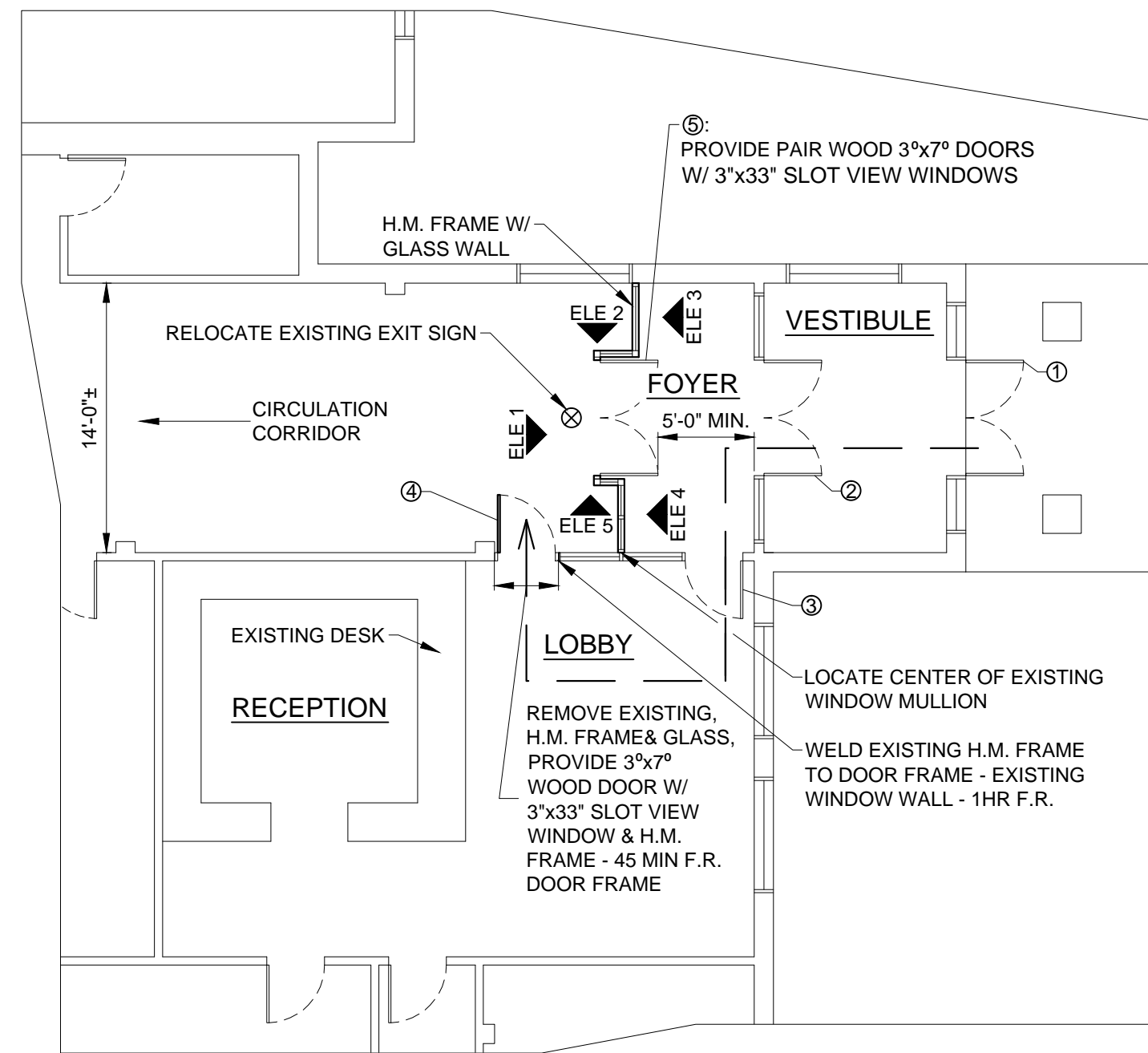

① MARLOW ELEMENTARY SCHOOL  
SCALE: 1/8" = 1'-0"

NOTE: SECURE H.M. FRAME TO FLOOR & WALLS. PROVIDE FRAMING SUPPORT AT CEILING TO ROOF STRUCTURE.

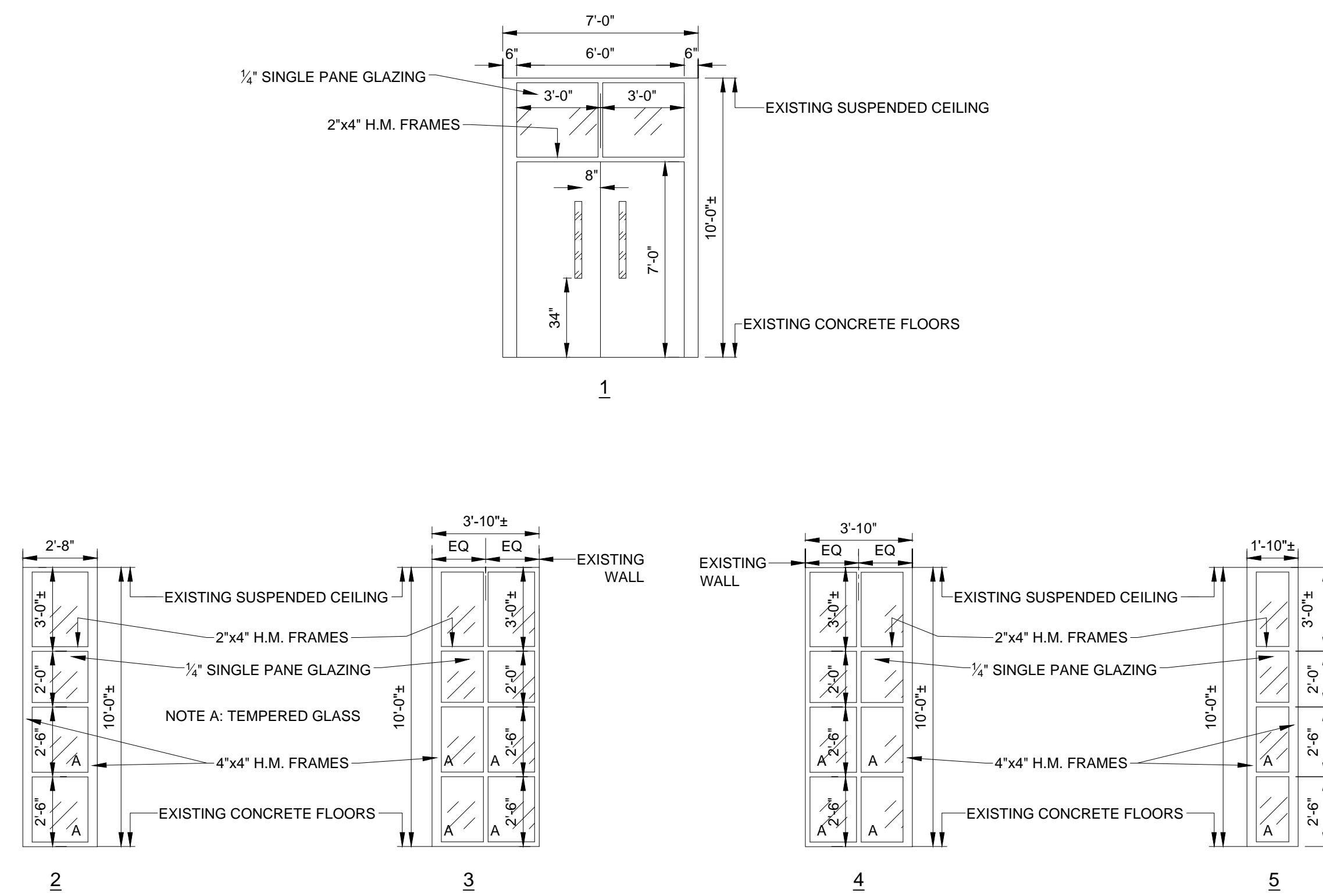

H.M. FRAME/GLASS WALL ELEVATIONS  
SCALE: 1/4" = 1'-0"

NOTE: SECURE H.M. FRAME TO FLOOR & WALLS. PROVIDE FRAMING SUPPORT AT CEILING TO ROOF STRUCTURE.

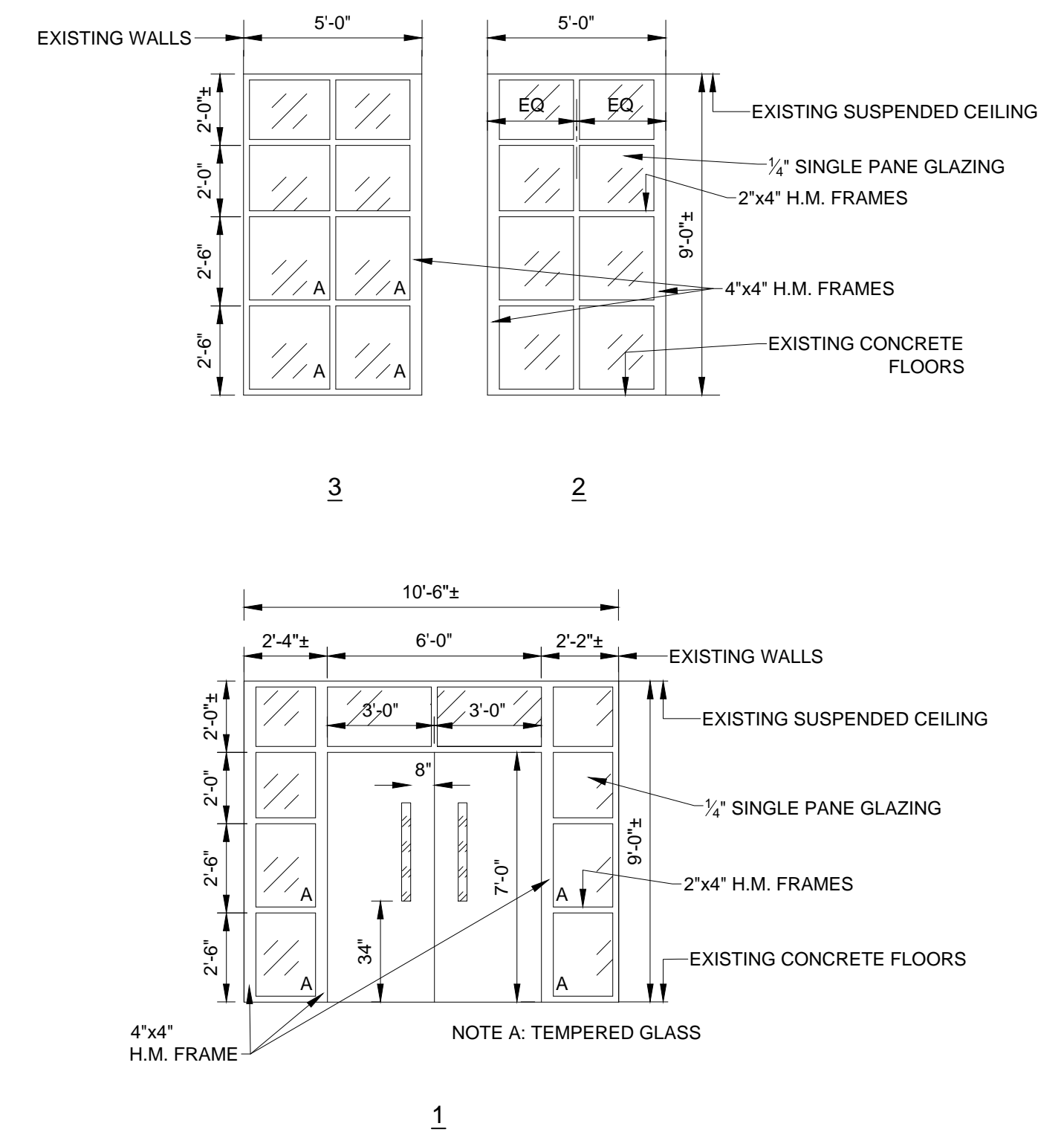

H.M. FRAME/GLASS WALL ELEVATIONS  
SCALE: 1/4" = 1'-0"

**CONSTRUCTION NOTES**

- A PROVIDE 3/8" METAL STUD W/ 1/2" TYPE X GWB. RATED WALLS SHALL BE 1 HR RATED. EXTEND TO ROOF DECK. PAINT TO MATCH EXISTING.
- B PROVIDE 2 LAYERS 5/8" TYPE X GWB OVER EXISTING STUD WALLS TO ROOF DECK FOR 1 HR RATING. PAINT TO MATCH EXISTING.
- C REMOVE (SAWCUT) 2 EXISTING H.M. GLASS PANELS. PROVIDE 3/8" METAL STUD W/ 1/2" TYPE X GWB. RATED WALLS SHALL BE 1 HR RATED. EXTEND TO ROOF DECK. PAINT TO MATCH EXISTING.
- D PROVIDE 3/8" METAL STUD W/ 1/2" GWB. PAINT TO MATCH EXISTING.

**ELECTRICAL NOTES**

- ELECTRICAL WORK SHALL BE PROVIDED IN ACCORDANCE WITH CURRENT NATIONAL ELECTRIC CODE.
- PROVIDE DUPLEX OUTLETS IN NEW WALLS PER CURRENT NATIONAL ELECTRIC CODE.

NOTE: SECURE H.M. FRAME TO FLOOR & WALLS. PROVIDE FRAMING SUPPORT AT CEILING TO ROOF STRUCTURE.

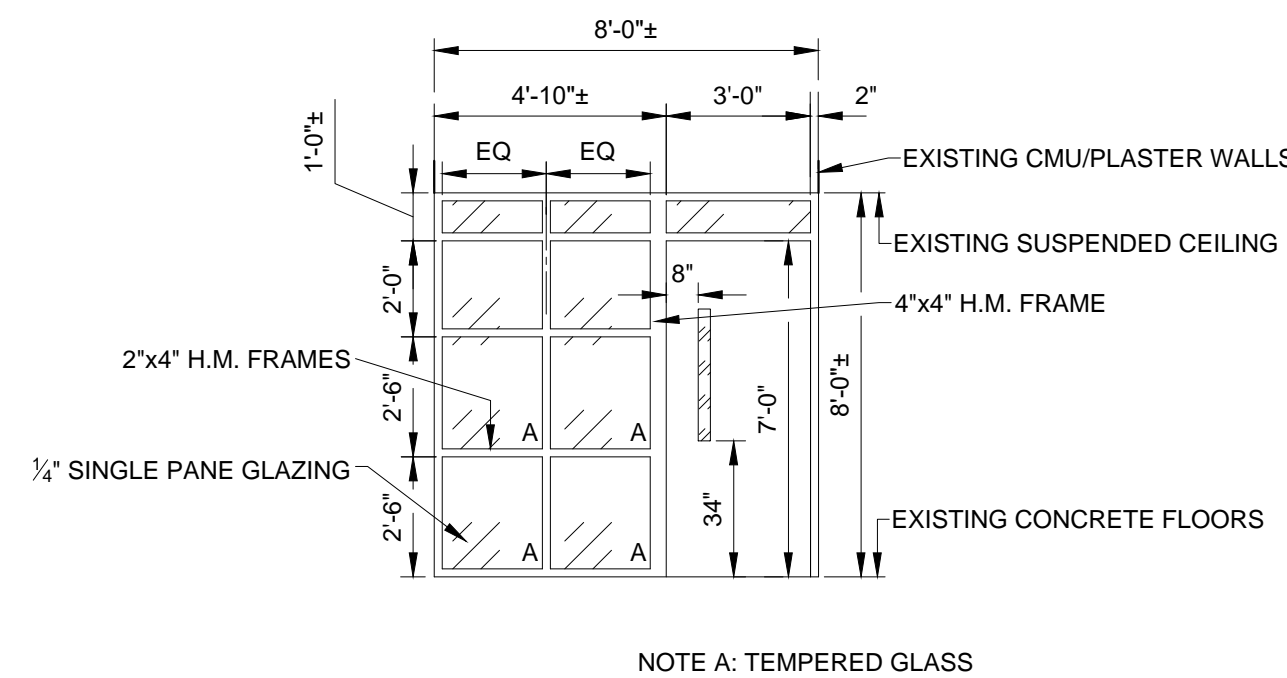

H.M. FRAME/GLASS WALL ELEVATION  
SCALE: 1/4" = 1'-0"

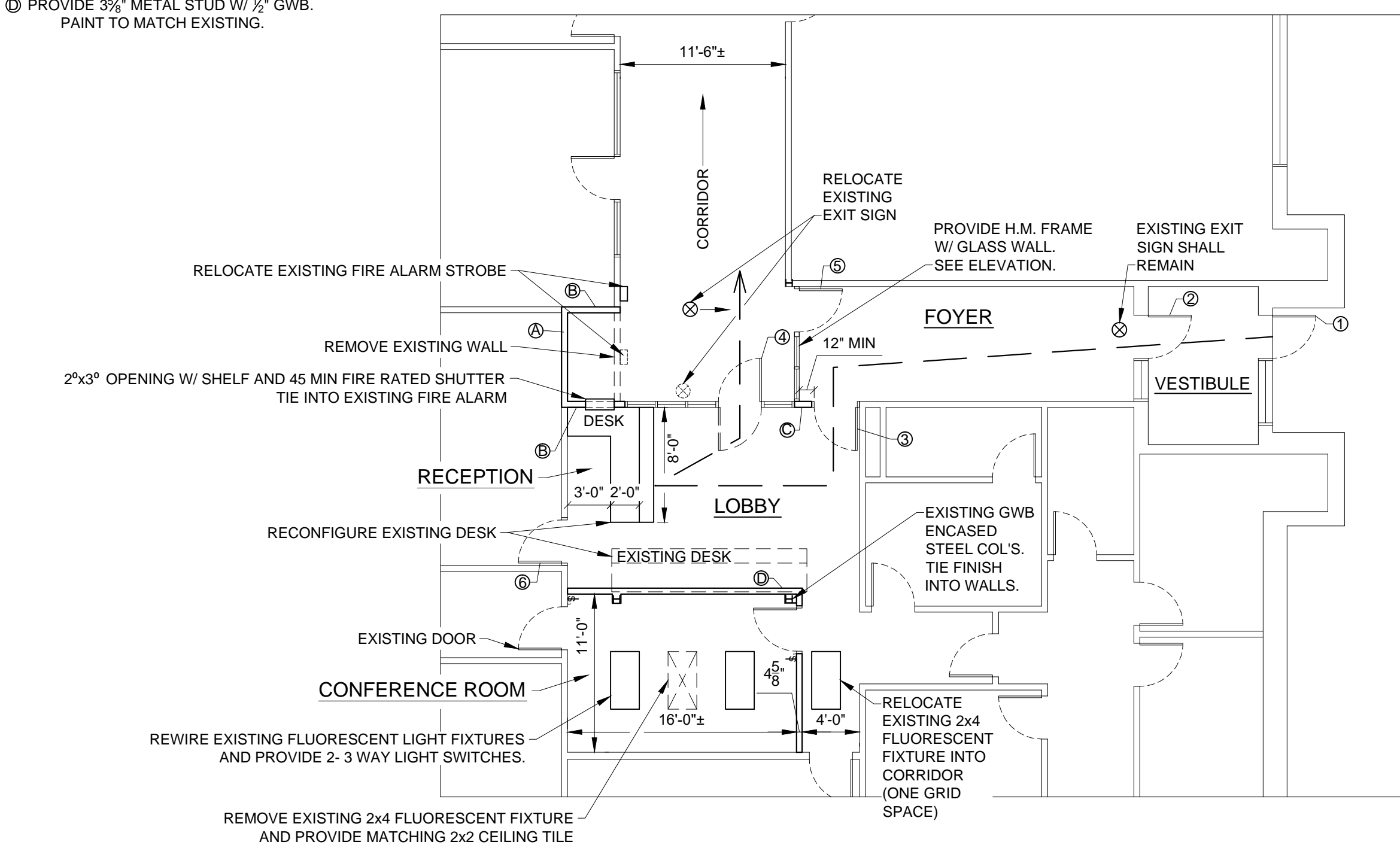

② WEST HENDERSON HIGH SCHOOL  
SCALE: 1/8" = 1'-0"

**CONSTRUCTION NOTES**

- ① EXISTING ENTRY DOORS: HARDWARE SHALL REMAIN.
- ② EXISTING VESTIBULE DOORS: HARDWARE SHALL REMAIN.
- ③ EXISTING LOBBY DOOR: EXISTING HARDWARE SHALL REMAIN.
- ④ EXISTING EXIT DOOR: PROVIDE ELECTRIC STRIKE WITH CONTROLLER AT DESK. PROVIDE LOCKSET W/ CLASSROOM INTRUDER FUNCTION.
- ⑤ FOYER DOORS: PROVIDE PANIC DEVICES, PULLS, VERTICAL RODS, HOLD OPEN CLOSERS, KICKPLATES.

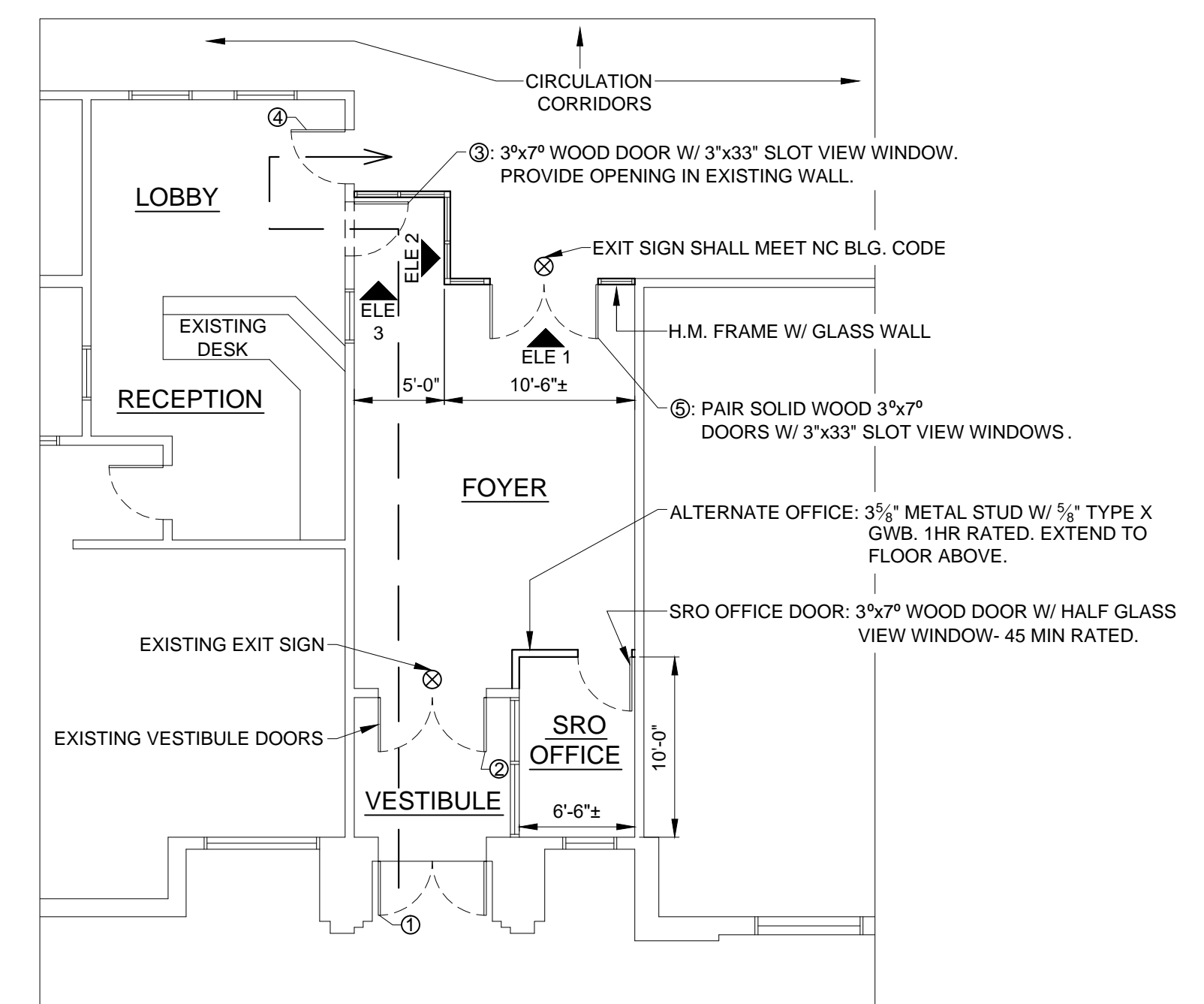

③ ETOWAH ELEMENTARY SCHOOL  
SCALE: 1/8" = 1'-0"

**DOOR NOTES**

DOORS SHALL BE 3"x7" WOOD DOORS W/ 3"x33" SLOT VIEW WINDOW. FRAMES SHALL BE H.M. DOOR/FRAMES IN 1HR RATED WALLS SHALL BE 45 MIN F.R.

**HARDWARE NOTES**

- ① EXISTING ENTRY DOORS: PROVIDE CAMERA, ELECTRIC STRIKE, & PAXTON CONTROLLER. COORDINATE WITH EXISTING PANIC HARDWARE.
- ② EXISTING VESTIBULE DOORS: HARDWARE SHALL REMAIN.
- ③ LOBBY DOOR: PROVIDE MORTISE LOCKSET (CLASSROOM FUNCTION), CLOSER, HINGES
- ④ EXIT DOOR: PROVIDE ELECTRIC STRIKE WITH CONTROLLER AT DESK. PROVIDE MORTISE LOCKSET W/ CLASSROOM INTRUDER FUNCTION, CLOSER, HINGES, KICKPLATE.
- ⑤ FOYER DOOR: PROVIDE PANIC DEVICES, PULLS, VERTICAL RODS, HOLD OPEN CLOSURES, KICKPLATES
- ⑥ RECEPTIONIST DOOR: PROVIDE MORTISE LOCKSET (CLASSROOM FUNCTION), CLOSER, HINGES



**HCPS ENTRANCE SECURITY RENOVATIONS**

Project Number: \_\_\_\_\_  
Checked: \_\_\_\_\_  
Drawn: A. Rognas  
Date: 11/15/18

**Floor Plans**

**A201**



**HARDWARE NOTES**

- ① EXISTING ENTRY DOORS: HARDWARE SHALL REMAIN.
- ② EXISTING VESTIBULE DOORS: HARDWARE SHALL REMAIN.
- ③ EXIT DOOR: PROVIDE ELECTRIC STRIKE WITH CONTROLLER AT DESK. PROVIDE PANIC DEVICES, PULLS, VERTICAL RODS, HOLD OPEN CLOSERS, KICKPLATES.

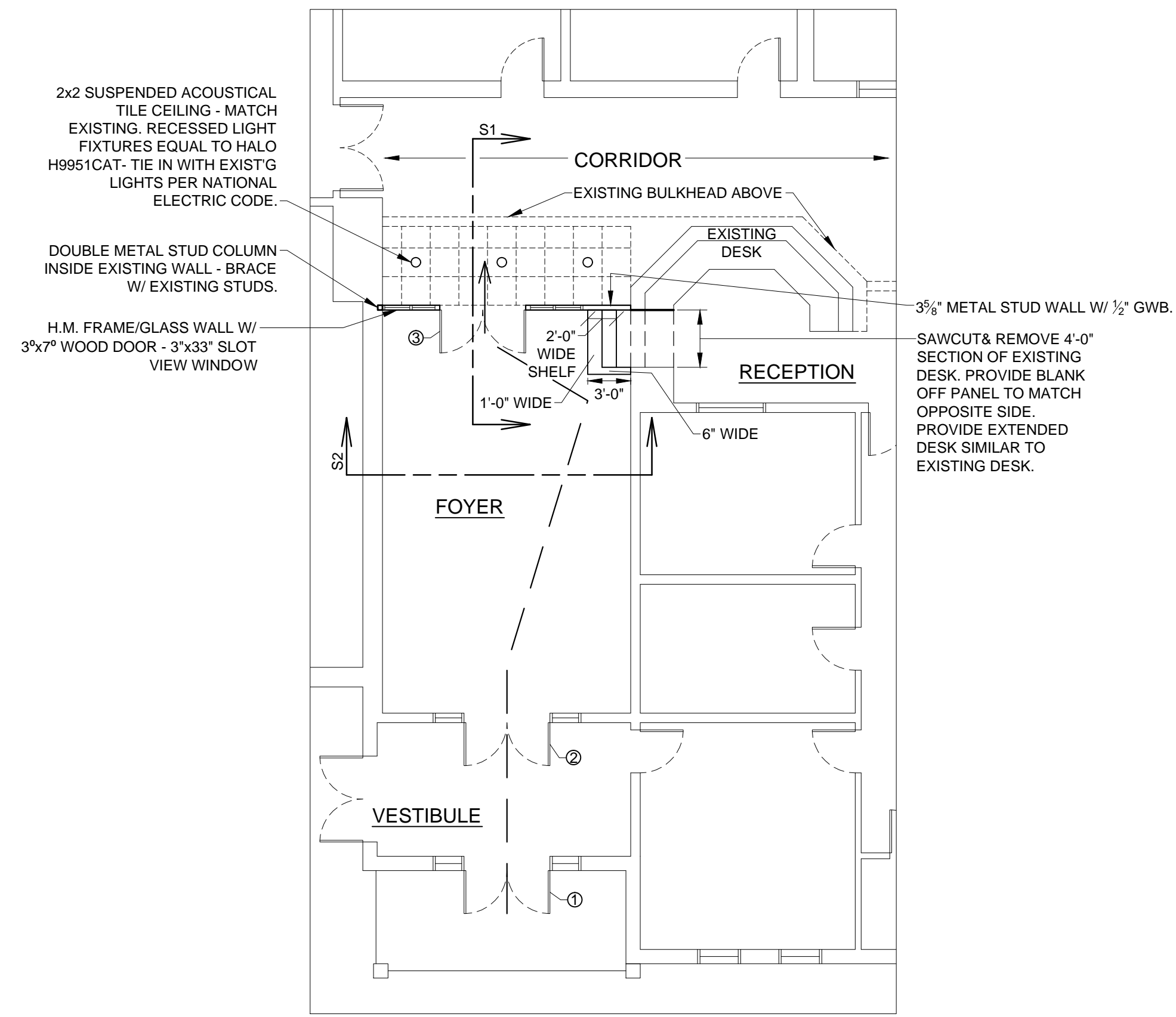

**DANA ELEMENTARY SCHOOL**  
 SCALE: 1/4" = 1'-0"

NOTE:  
 1. EXISTING WALLS/CEILING ARE METAL FRAMING W/ GWB  
 2. NOTE A=TEMPERED GLASS

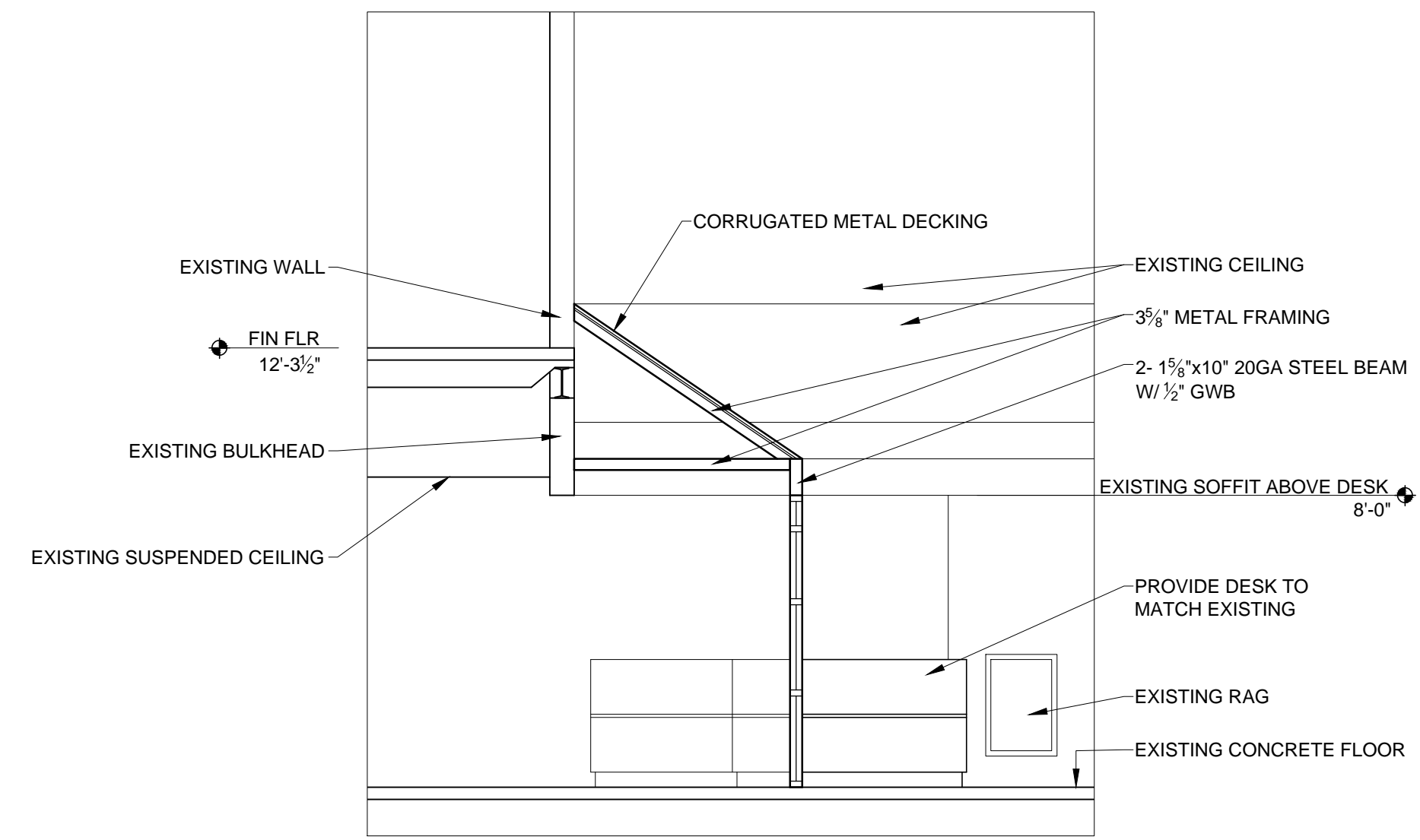

**S1- SECTION**  
 SCALE: 1/4" = 1'-0"

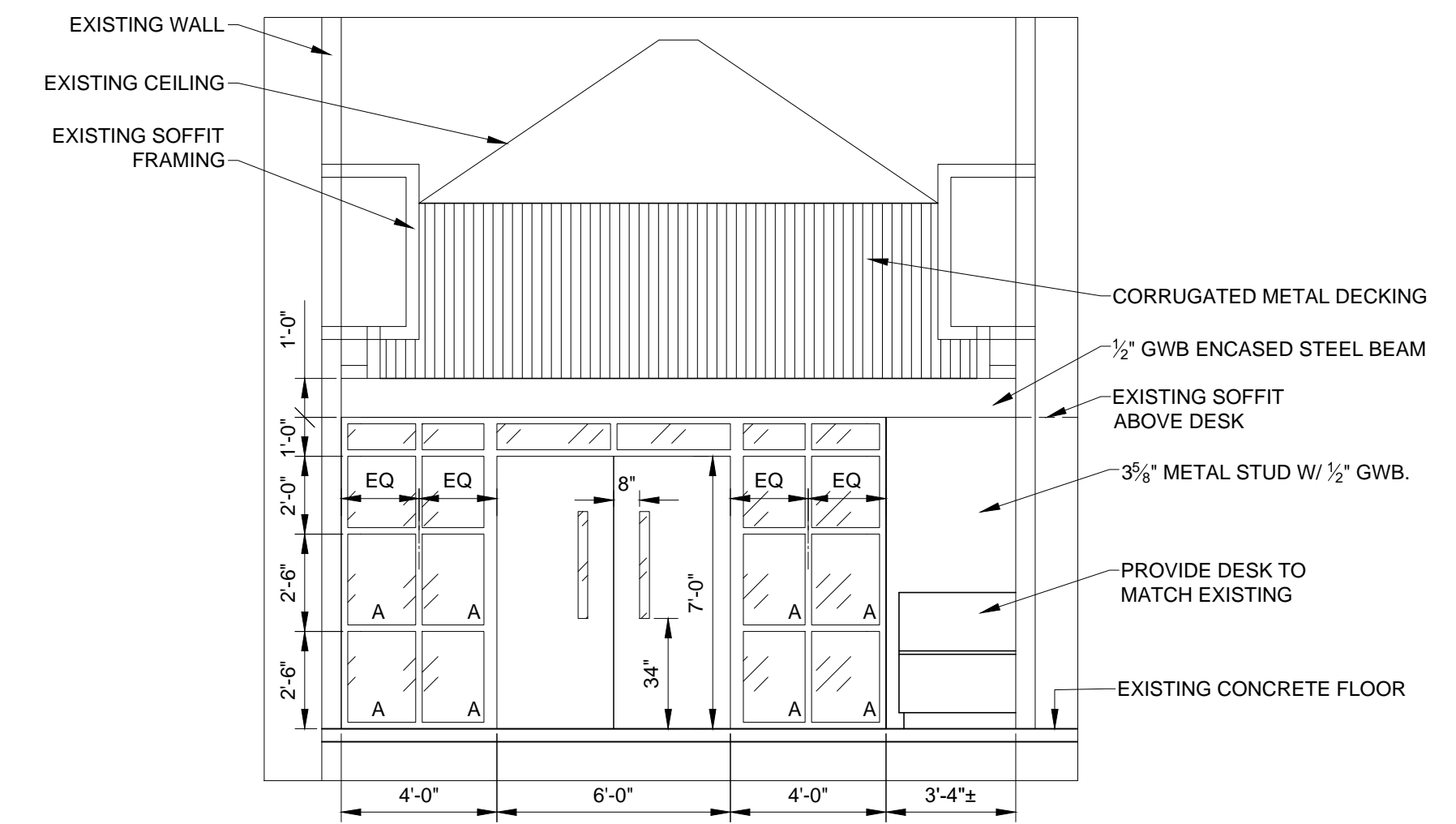

**S2- SECTION**  
 SCALE: 1/4" = 1'-0"

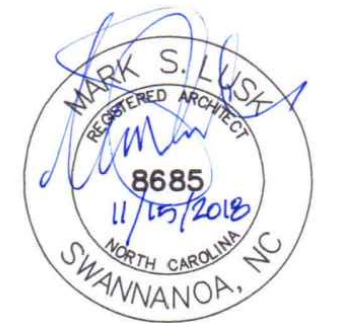

**HCPS ENTRANCE SECURITY RENOVATIONS**

Project Number: \_\_\_\_\_  
 Checked: \_\_\_\_\_  
 Drawn: A. Rognas  
 Date: 11/15/18

**Floor Plan**

**A202**

© Copyright 2018. All Rights Reserved. Reproduction, copying or use of this drawing and designs shown therein without written consent of Mark Lusk Architecture PLLC is prohibited and any infringement is subject to legal action.