

**REQUEST FOR BOARD ACTION**

**HENDERSON COUNTY  
BOARD OF COMMISSIONERS**

**MEETING DATE:** June 15<sup>th</sup>, 2022

**SUBJECT:** Inclusive Playground Update

**PRESENTER:** Christopher Todd and Carleen Dixon

**ATTACHMENTS:** Yes

1. Playground Proposal

**SUMMARY OF REQUEST:**

The Board of Commissioners will be provided with an update on the inclusive playground project.

**BOARD ACTION REQUESTED:**

No specific Board Action is requested, this item is for informational purposes only.

**Suggested Motion:**

No motion suggested.

# Jackson Park

Proposal # 405-154080-1

May 20, 2022

Presented by

**Barrs Recreation, LLC**





May 20, 2022

Carleen Dixon  
Henderson County  
801 4th Ave East  
Hendersonville, NC 28792

Dear Carleen Dixon:

Barrs Recreation, LLC is delighted to provide Henderson County with this playground equipment proposal.

This design was developed with your specific needs in mind, and we look forward to discussing this project further with you to ensure your complete satisfaction. Barrs Recreation, LLC is confident that this proposal will satisfy Henderson County's functional, environmental, and safety requirements -- and most importantly -- bring joy and excitement to the children and families directly benefiting from your new playground.

You have our personal commitment to support this project and your organization in every manner possible, and we look forward to continue developing a long-standing relationship with Henderson County. We appreciate your consideration and value this opportunity to earn your business.

Sincerely,

Ashley Barrs  
Barrs Recreation, LLC  
36 Diane Street  
Pittsboro, NC 27312

## **Design Summary**

Barrs Recreation, LLC is very pleased to present this Proposal for consideration for the Jackson Park located in Hendersonville. BCI Burke Company, LLC has been providing recreational playground equipment for over 90 years and has developed the right mix of world-class capabilities to meet the initial and continuing needs of Henderson County. We believe our proposal will meet or exceed your project's requirements and will deliver the greatest value to you.

The following is a summary of some of the key elements of our Proposal:

- Project Name: Jackson Park
- Project Number: 405-154080-1
- User Capacity: 294
- Age Groups: Ages 2-5 years, 5-12 years
- Dimensions: 69' 11" x 99' 1"
- Designer Name: Leah Kirssin

Barrs Recreation, LLC has developed a custom playground configuration based on the requirements as they have been presented for the Jackson Park playground project. Our custom design will provide a safe and affordable playground environment that is aesthetically pleasing, full of fun for all users and uniquely satisfies your specific requirements. In addition, proposal # 405-154080-1 has been designed with a focus on safety, and is fully compliant with ASTM F1487 and CPSC playground safety standards.

We invite you to review this proposal for the Jackson Park playground project and to contact us with any questions that you may have.

Thank you in advance for giving us the opportunity to make this project a success.

INFORMATION  
MINIMUM FALL ZONE  
SURFACED WITH  
RESILIENT MATERIAL  
AREA

5440 SQ.FT.

PERIMETER  
748 FT.

STRUCTURE SIZE  
69' 11" x 99' 1"

STRUCTURE IS DESIGNED  
FOR CHILDREN AGES:

- 6-23 MONTH OLDS
- 2-5 YEAR OLDS
- 5-12 YEAR OLDS
- 13 + YEAR OLDS



Registered  
to ISO 9001



Registered  
to ISO 14001



To verify product certification,  
visit [www.ipema.org](http://www.ipema.org)

The play components identified  
in this plan are IPEMA  
certified. The use and layout of  
these components conform to the  
requirements of ASTM F1487.  
To verify product certification,  
visit [www.ipema.org](http://www.ipema.org)

The space requirements shown  
here are to ASTM standards.  
Requirements for other standards  
may be different.

The use and layout of play  
components identified in this plan  
conform to the CPSC guidelines.  
U.S. CPSC recommends the  
separation of age groups in  
playground layouts.

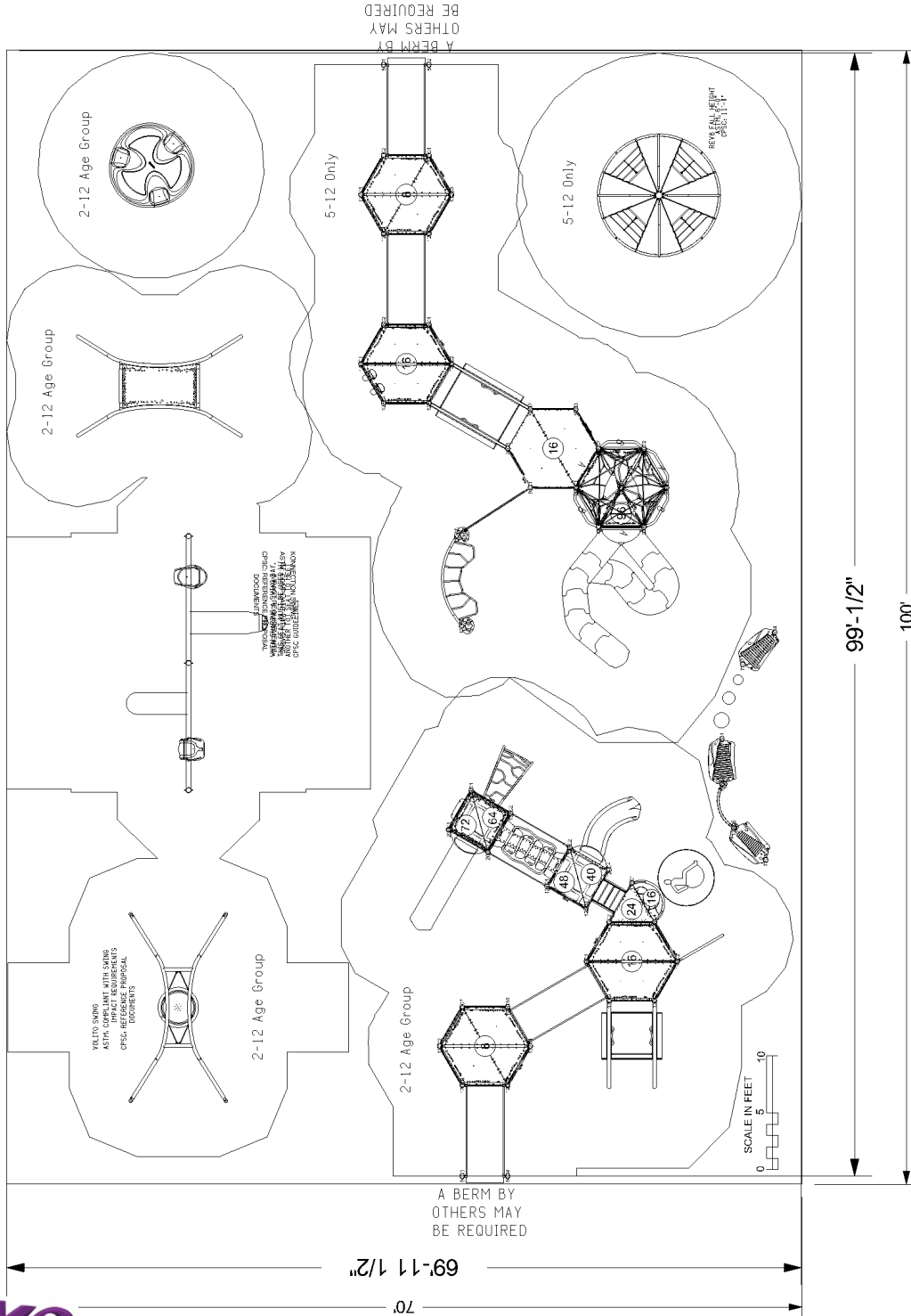

**WARNING!**

ACCESSIBLE SAFETY SURFACING MATERIAL IS REQUIRED BENEATH  
AND AROUND THIS EQUIPMENT.  
FOR SLIDE FALL ZONE SURFACING AREA SEE CPSC's Handbook for  
Public Playground Safety.  
PLATFORM HEIGHTS ARE IN INCHES ABOVE RESILIENT MATERIAL.

**ADA ACCESSIBILITY GUIDELINE (ADAAG CONFORMANCE)**

NUMBER OF PLAY EVENTS:	46
NUMBER OF ELEVATED PLAY EVENTS:	27
NUMBER OF ELEVATED PLAY EVENTS ACCESSIBLE BY RAMP:	PROVIDED: 16
NUMBER OF ELEVATED PLAY EVENTS ACCESSIBLE BY TRANSFER SYSTEM:	PROVIDED: 22
NUMBER OF ELEVATED PLAY EVENTS ACCESSIBLE BY RAMP OR TRANSFER SYSTEM:	PROVIDED: 19
NUMBER OF GROUND LEVEL PLAY EVENTS:	PROVIDED: 14
NUMBER OF TYPES OF GROUND LEVEL PLAY EVENTS:	RECD: 7
	RECD: 7
	RECD: 0
	RECD: 0



SERIES: Basics, Intensity, Nucleus

SITE PLAN

DRAWN BY: Leah Kirssin

Jackson Park

801 4th Ave East

Hendersonville, NC 28792

Barrs Recreation, LLC

405-154080-1

May 20, 2022

ITEM	COMP	DESCRIPTION
1	270-0008	8" CLOSURE PLATE, ELLIPSE
2	270-0120	EVOLUTION UNITARY ENCLOSURE
3	270-0122	EVOLUTION OFFSET ENCLOSURE
4	270-0129	TRIANGLE PLATFORM
5	270-0131	HEXAGONAL PLATFORM S5P
6	270-0221	8" RISE RAMP W/ GUARDRAILS
7	270-0223	8" RISE ENTRANCE RAMP W/ GUARDRAILS
8	270-0301	SPLIT SQUARE PLATFORM/CLOSURE
9	370-0039	EVOLUTION 24" TRANSITION STRUT
10	370-0842	APEX HOLE CLIMBER 2-5
11	370-0862	TREE BRANCH CLIMBER 48"
12	370-1608	OVISTEP LAUNCH PAD
13	370-1651	TRANGO CLIMBER, POST TO PLATFORM
14	370-1676	STRAIGHT HORIZONTAL LADDER
15	370-1682	BETA CLIMBER 64"-72"
16	370-1703	NUCLEUS CORE CROSS SUPPORT
17	370-1705	NUCLEUS CORE CLIMBER, 8"
18	370-1715	MESA CLIMBER
19	470-0075	CRESCENT PLATFORM
20	470-0574	VIPER II OVER UNDER 96"
21	470-0754	VELO SLIDE 64"-72", W/O HOOD
22	470-0802	MONACO SLIDE, 32"-40"
23	470-0804	SLIDE HOOD, LOW SIDE WALL
24	470-0808	EVOLUTION ROOF BOTTOM EDGE
25	470-0809	SQUARE ROOF TOP EDGE, ONE SIDE
26	470-0813	EVOLUTION HEX ROOF
27	470-0867	EVOLUTION SQUARE ROOF
28	550-0099	TOT SEAT, 7' & 8' SINGLE, STD CHAIR
29	550-0171	BELT SEAT, 8' SINGLE, STD CHAIR
30	550-0171	FREEDOM SWING SEAT, 8' BEAM
31	550-0186	VOLUTO
32	550-0191	CONNECTION SWING
33	550-0201	SINGLE POST SWING ASSEMBLY
34	550-0202	SINGLE POST SWING ADD-ON 5'
35	550-9118	BRAVA UNIVERSAL SWING
36	560-0055	PLAYENSEMBLE CIRQUE DRUM
37	560-0056	PLAYENSEMBLE CIRQUE DRUM
38	560-0057	PLAYENSEMBLE CIRQUE DRUM
39	560-0576	REV8
40	560-2579	VOLTA INCLUSIVE SPINNER
41	570-0102	INNOVA BRIDGE
42	570-0103	INNOVA ROCKER
43	570-0410	PLAYENSEMBLE TITAN CHIMES
44	570-0411	PLAYENSEMBLE SUPINE CHIMES
45	570-0412	PLAYENSEMBLE TERRA METAL
46	570-0413	PLAYENSEMBLE SUPINE CHIMES
47	570-0557	COUNTER PANEL, BELOW PLATFORM
48	570-0622	PLATFORM ROLL GUARD
49	570-0811	BRAILLE PANEL
50	570-0840	SHAPES 2-SIDED PLAY PANEL
51	570-0842	ABC 2-SIDED PLAY PANEL
52	570-0846	SPANISH 2-SIDED PLAY PANEL
53	570-0848	SIGNING 2-SIDED PLAY PANEL
54	570-1858	3-IN-A-RROW PANEL, ABOVE PLATFORM
55	570-2558	SPIRAL SPINNER ACCESSIBLE PLATFORM
56	570-2662	CRAZY MAZE 2-SIDED PLAY PANEL
57	570-2664	BEE PANEL
58	570-2666	CAR ACCESSIBLE REACH PANEL
59	570-2669	MAZE ACCESSIBLE REACH PANEL
60	570-2670	DRUM ACCESSIBLE REACH PANEL
61	570-2712	HIDE THE NUMBERS 2-SIDED PLAY PANEL
62	570-2735	CLASSIC GAME PANEL

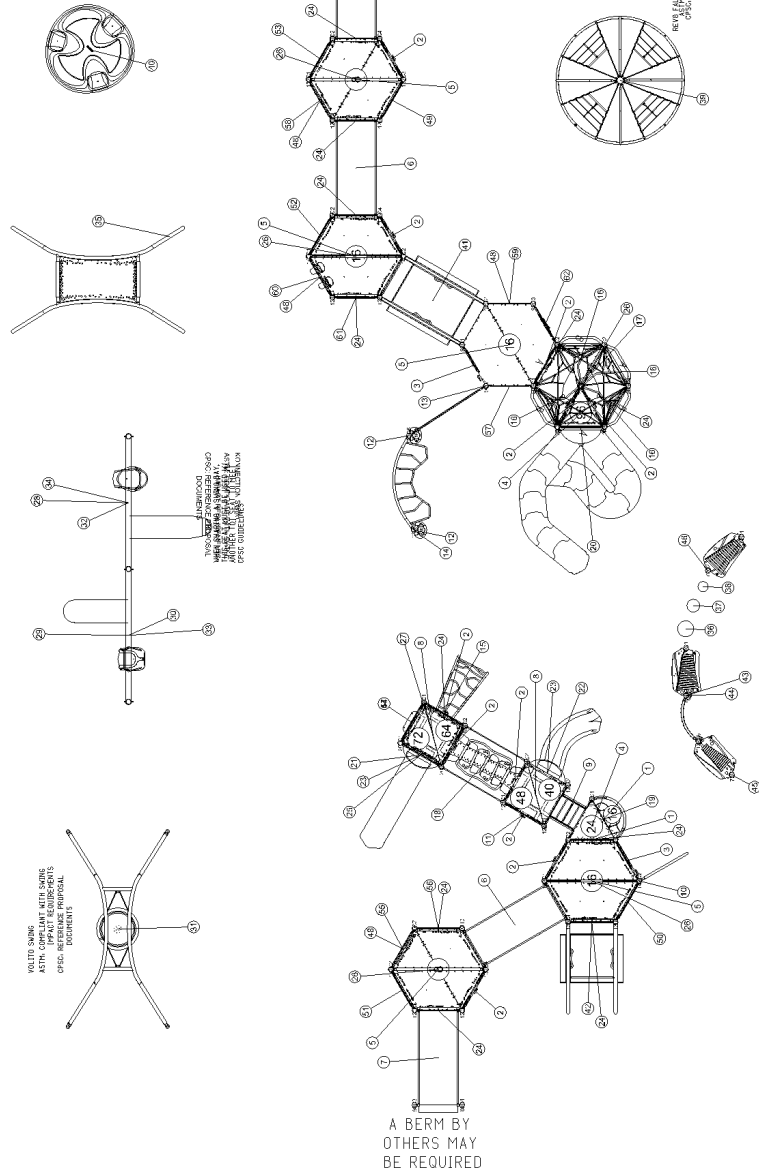

May 20, 2022

SERIES: Basics, Intensity, Nucleus  
 COMPONENT PLAN  
 DRAWN BY: Leah Kirssin

Jackson Park  
 801 4th Ave East  
 Hendersonville, NC 28792

Barrs Recreation, LLC  
 405-154080-1



SERIES: Basics, Intensity, Nucleus  
 ELEVATION PLAN  
 DRAWN BY: Leah Kirssin

Jackson Park  
 801 4th Ave East  
 Hendersonville, NC 28792

Barrs Recreation, LLC  
 405-154080-1

BCI Burke Company, LLC PO Box 549 Fond du Lac, Wisconsin 54936-0549 Telephone 920-921-9220

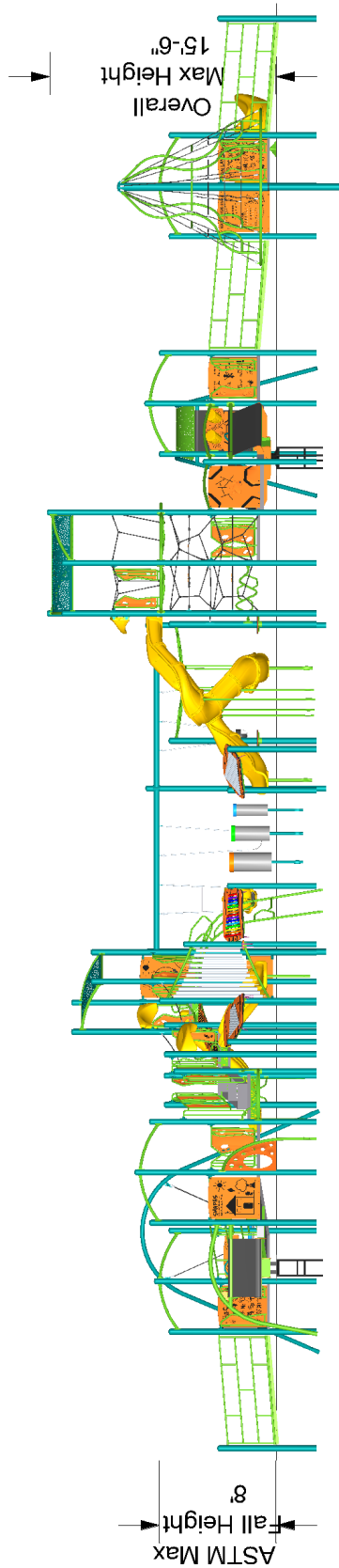

Rev# Fall Height:  
 ASTM 6' 0"  
 CPSC 11' 0"

The protective surfacing for this design must accommodate the critical fall height.

May 20, 2022







**Proposal Prepared for:**  
 Carleen Dixon  
 Henderson County  
 801 4th Ave East  
 Hendersonville, NC 28792  
 Phone: 828-697-4884

**Project Location:**  
 Jackson Park  
 801 4th Ave East  
 Hendersonville, NC 28792

**Proposal Prepared by:**  
 Barrs Recreation, LLC  
 36 Diane Street  
 Pittsboro, NC 27312  
 Phone: 919-781-4870  
 Fax: 919-781-5779  
 johnb@barrsrec.com

Ashley Barrs  
 Phone: 919-781-4870  
 Fax:  
 ashley@barrsrec.com

Component No.	Description	Qty	User Cap	Ext. User Cap	Weight	Ext. Weight
Phase One						
Intensity						
370-1608	OVISTEP LAUNCH PAD	2	1	2	10	20
370-1676	STRAIGHT HORIZONTAL LADDER, N...	1	6	6	58	58
Nucleus						
072-0500-120C	5" OD X 120" CAPPED POST	6	0	0	63	378
072-0500-128C	5" OD X 128" CAPPED POST	4	0	0	67	268
072-0500-132C	5" OD X 132" CAPPED POST	2	0	0	69	138
072-0500-140C	5" OD X 140" CAPPED POST	2	0	0	74	148
072-0500-172C	5" OD X 172" CAPPED POST	1	0	0	90	90
072-0500-208C	5" OD X 208" CAPPED POST	4	0	0	109	436
072-0500-220C	5" OD X 220" CAPPED POST	2	0	0	115	230
072-0500-80C	5" OD X 80" CAPPED POST	2	0	0	42	84
072-0500-92C	5" OD X 92" CAPPED POST	3	0	0	48	144
072-0500-96C	5" OD X 96" CAPPED POST	1	0	0	51	51
270-0120	EVOLUTION UNITARY ENCLOSURE	5	0	0	34	170
270-0122	EVOLUTION OFFSET ENCLOSURE	1	0	0	34	34
270-0129	TRIANGLE PLATFORM	1	2	2	48	48
270-0131	HEXAGONAL PLATFORM S5P	3	12	36	287	861
270-0221	8" RISE RAMP W/ GUARDRAILS	1	10	10	356	356
270-0223	8" RISE ENTRANCE RAMP W/ GUAR...	1	10	10	377	377
370-1651	TRANGO CLIMBER, POST TO POST	1	5	5	32	32
370-1703	NUCLEUS CORE CROSS SUPPORT	4	0	0	32	128
370-1705	NUCLEUS CORE CLIMBER, 8'	1	12	12	161	161
470-0574	VIPER II OVER UNDER 96	1	8	8	479	479
470-0808	EVOLUTION ROOF BOTTOM EDGE	6	0	0	13	78
470-0813	EVOLUTION HEX ROOF	3	0	0	211	633
570-0102	INNOVA BRIDGE	1	18	18	847	847
570-0622	PLATFORM ROLL GUARD	3	0	0	8	24
570-0811	BRAILLE PANEL	1	4	4	55	55
570-0846	SPANISH 2-SIDED PLAY PANEL	1	2	2	44	44
570-0848	SIGNING 2-SIDED PLAY PANEL	1	2	2	44	44
570-2664	BEE PANEL	1	2	2	45	45
570-2668	CAR ACCESSIBLE REACH PANEL	1	2	2	23	23
570-2669	MAZE ACCESSIBLE REACH PANEL	1	2	2	16	16
570-2670	DRUM ACCESSIBLE REACH PANEL	1	2	2	23	23
570-2712	HIDE THE NUMBERS 2-SIDED PLAY...	1	2	2	70	70



570-2735	CLASSIC GAME PANEL	1	2	2	67	67
600-0104	NPPS SUPERVISION SAFETY KIT	1	0	0	3	3
660-0103	MAINTENANCE KIT, STRUCTURE	1	0	0	7	7
660-0104	INSTALLATION KIT, STRUCTURE	1	0	0	5	5

Phase One User Capacity: 129  
Phase One Weight: 6,675 lbs.  
Phase One Price: \$93,455

Phase Two

Intensity

370-0842	APEX HOLE CLIMBER 2-5	1	2	2	55	55
----------	-----------------------	---	---	---	----	----

Nucleus

072-0500-116C	5" OD X 116" CAPPED POST	1	0	0	61	61
072-0500-120C	5" OD X 120" CAPPED POST	4	0	0	63	252
072-0500-124C	5" OD X 124" CAPPED POST	4	0	0	65	260
072-0500-132C	5" OD X 132" CAPPED POST	2	0	0	69	138
072-0500-136C	5" OD X 136" CAPPED POST	4	0	0	71	284
072-0500-148C	5" OD X 148" CAPPED POST	2	0	0	78	156
072-0500-184C	5" OD X 184" CAPPED POST	2	0	0	96	192
072-0500-200C	5" OD X 200" CAPPED POST	2	0	0	105	210
072-0500-80C	5" OD X 80" CAPPED POST	2	0	0	42	84
270-0009	8" CLOSURE PLATE, ELLIPSE	2	0	0	8	16
270-0120	EVOLUTION UNITARY ENCLOSURE	6	0	0	34	204
270-0122	EVOLUTION OFFSET ENCLOSURE	1	0	0	34	34
270-0129	TRIANGLE PLATFORM	1	2	2	48	48
270-0131	HEXAGONAL PLATFORM S5P	2	12	24	287	574
270-0221	8" RISE RAMP W/ GUARDRAILS	1	10	10	356	356
270-0223	8" RISE ENTRANCE RAMP W/ GUAR...	1	10	10	377	377
270-0301	SPLIT SQUARE PLATFORMCLOSURE ...	2	4	8	108	216
370-0039	EVOLUTION 24" TRANSITION STAI...	1	4	4	181	181
370-0862	TREE BRANCH CLIMBER 48"	1	2	2	17	17
370-1682	BETA CLIMBER 64"-72"	1	3	3	57	57
370-1715	MESA CLIMBER	1	4	4	143	143
470-0075	CRESCENT PLATFORM	1	1	1	52	52
470-0754	VELO SLIDE 64"-72", W/O HOOD	1	2	2	111	111
470-0802	MONACO SLIDE, 32"-40"	1	2	2	71	71
470-0804	SLIDE HOOD, LOW SIDE WALL	2	0	0	32	64
470-0808	EVOLUTION ROOF BOTTOM EDGE	5	0	0	13	65
470-0809	SQUARE ROOF TOP EDGE, ONE SIDE	1	0	0	13	13
470-0813	EVOLUTION HEX ROOF	2	0	0	211	422
470-0867	EVOLUTION SQUARE ROOF	1	0	0	76	76
570-0103	INNOVA ROCKER	1	14	14	703	703
570-0557	COUNTER PANEL, BELOW PLATFORM	1	4	4	37	37
570-0622	PLATFORM ROLL GUARD	1	0	0	8	8
570-0840	SHAPES 2-SIDED PLAY PANEL	1	2	2	44	44
570-0842	ABC 2-SIDED PLAY PANEL	1	2	2	44	44
570-1858	3-IN-A-ROW PANEL, ABOVE PLATF...	1	2	2	45	45
570-2558	SPIRAL SPINNER ACCESSIBLE REA...	1	4	4	23	23
570-2662	CRAZY MAZE 2-SIDED PLAY PANEL	1	2	2	44	44

Phase Two User Capacity: 104  
Phase Two Weight: 5,737 lbs.  
Phase Two Price: \$76,257



Phase Three

Nucleus

072-0500-108C	5" OD X 108" CAPPED POST	1	0	0	57	57
072-0500-128C	5" OD X 128" CAPPED POST	1	0	0	67	67
072-0500-72C	5" OD X 72" CAPPED POST	4	0	0	38	152
560-0055	PLAYENSEMBLE CIRQUE DRUM V	1	2	2	48	48
560-0056	PLAYENSEMBLE CIRQUE DRUM IV	1	1	1	32	32
560-0057	PLAYENSEMBLE CIRQUE DRUM III	1	1	1	25	25
570-0410	PLAYENSEMBLE TITAN CHIMES	1	2	2	121	121
570-0411	PLAYENSEMBLE SUPINE CHIMES HUE	1	2	2	93	93
570-0412	PLAYENSEMBLE TERRA METALLOPHO...	1	2	2	93	93
570-0413	PLAYENSEMBLE SUPINE CHIMES	1	2	2	93	93

Phase Three User Capacity: 12  
 Phase Three Weight: 781 lbs.  
 Phase Three Price: \$26,680

Phase Four

Burke Basics

550-0099	TOT SEAT, 7' & 8' SINGLE, STD...	1	1	1	12	12
550-0111	BELT SEAT, 8' SINGLE, STD CHA...	1	1	1	10	10
550-0171	FREEDOM SWING SEAT, 8' BEAM, ...	1	1	1	38	38
550-0186	VOLITO	1	4	4	413	413
550-0191	KONNECTION SWING	1	2	2	64	64
550-0201	SINGLE POST SWING ASSEMBLY 5"...	1	0	0	220	220
550-0202	SINGLE POST SWING ADD-ON 5" OD	1	0	0	145	145
550-9118	BRAVA UNIVERSAL SWING	1	6	6	530	530
560-0576	REV8	1	25	25	1,343	1,343
560-2579	VOLTA INCLUSIVE SPINNER	1	9	9	475	475
660-0101	INSTALL KIT, BURKE BASICS - P...	1	0	0	2	2

Phase Four User Capacity: 49  
 Phase Four Weight: 3,252 lbs.  
 Phase Four Price: \$49,524

Total User Capacity: 294  
 Total Weight: 16,445 lbs.  
 Total Price: \$245,916

Information is relative to the May 20 2022 4:35AM database.

**Special Notes:**

Prices do not include freight, unloading, material storage, site excavation/preparation, removal of existing equipment, removal of excess soil from footing holes, site security, safety surfacing, installation, or sales tax (if applicable). Prices are based on standard colors per CURRENT YEAR BCI Burke Catalog. Custom colors, where available, would be an extra charge. **Pricing is valid for 30 days from the date of this proposal.**



## **Selected Color List**

<b>Color Group</b>	<b>Color</b>
<i>Phase 1</i>	
Platform	Gray
Accessory	Lime
1 Color Extruded/Flat	Orange
2 Color Extruded/Flat (outer)	Orange
2 Color Extruded/Flat (inner)	Black
Post	Aqua
Kore Konnect	Aqua
Rotomolded	Yellow
Drums	Yellow
<i>Phase 2</i>	
Platform	Gray
Accessory	Lime
Kore Konnect	Aqua
1 Color Extruded/Flat	Orange
2 Color Extruded/Flat (outer)	Orange
2 Color Extruded/Flat (inner)	Black
Post	Aqua
Rotomolded	Yellow
<i>Phase 3</i>	
Accessory	Lime
2 Color Extruded/Flat (outer)	Orange
2 Color Extruded/Flat (inner)	Black
Post	Aqua
1 Color Extruded/Flat	Orange
<i>Phase 4</i>	
Accessory	Lime
2 Color Extruded/Flat (outer)	Orange
2 Color Extruded/Flat (inner)	Black
Post	Aqua
Contemporary Swing Fittings	Aqua
Rotomolded	Yellow
Platform	Gray



## Volito Swing

### Safety Standards & Guidelines - Reference Information

The Volito Swing was designed to allow multiple children to swing and engage together. For many years the only swings available for kids to use together were tire swings, which are fun and challenging but presented opportunities for improvement. Tire swings are able to rotate and pivot in all directions, often in an unpredictable manner and, because they aren't easy to propel while sitting on them, other children often have to push the swing to gain and maintain motion. The Volito Swing, along with many similar swings in this growing market trend, provides a multi-user swing that moves in a single axis to-fro motion.

The Volito Swing is IPEMA Certified and meets or exceeds the requirements of ASTM F1487-17, which is recognized as the standard of care in the playground industry. This ASTM public playground safety standard is revised every two to three years to remain current with innovation and market trends.

The CPSC Public Playground Safety Handbook hasn't been revised since 2008 and doesn't include new product categories that have been innovated in recent years. There are a couple of points to note when deciding to purchase a multi-user swing:

- Multi-user swings are innovative and CPSC Public Playground Safety Handbook doesn't have a standard that specifically covers them.
- CPSC 5.3.8.3.1 – CPSC recommends that belt swing seats should be designed to accommodate no more than one user at any time. While the Volito Swing is a single axis swing, it is clearly not a belt seat.
- CPSC 2.3.1 – CPSC says that swings intended for more than one user are not recommended because of their greater mass, as compared to single occupancy swings, presents a risk of impact injury.
  - The ASTM safety standard, F1487, was revised in 2011 to add maximum impact requirements for swings and the Volito Swing has been tested and is compliant with ASTM impact requirements.
  - CPSC has written a letter stating that “the swing impact test in F1487-11 is a reasonable approach to address the concerns posed by unoccupied, heavy, multiple occupancy swings.”
- CPSC has always included an exemption to both recommendations listed above for tire swings, which are multiple occupancy swings that are suspended from a single pivot and permit swinging in any direction.
- CPSC also emphasizes that their Handbook provides recommendations, not requirements. If a jurisdiction adopts the Handbook's recommendations as mandatory requirements, that jurisdiction would need to determine how the requirements should be applied in any particular instance.



## Konnection Swing™

### Safety Standards & Guidelines - Reference Information

The Konnection Swing was designed to provide an intergenerational play opportunity and offer everyone the childhood joy of swinging! While researching the use of swings, two trends stood out to us - caregivers pushing infants in bucket seat swings and adults swinging with children on their lap. Both situations could be improved with the design of a swing designed to foster connection and increase safety. The Konnection Swing was developed as a direct result of this. The overall design is focused on fostering true connection in both eye contact and proximity leading to increased engagement for all users. Hands-free swinging allows the caregiver to hold, interact and play with the child as they both experience the thrill of swinging together.

The Konnection Swing is IPEMA Certified and meets or exceeds the requirements of ASTM F1487-17, which is recognized as the standard of care in the playground industry. This ASTM public playground safety standard is revised every two to three years to remain current with innovation and market trends.

The CPSC Public Playground Safety Handbook hasn't been revised since 2008 and doesn't include new product categories that have been innovated in recent years. There are a couple of points to note when deciding to purchase a multi-user swing:

- Multi-user swings are innovative and CPSC Public Playground Safety Handbook doesn't have a standard that specifically covers them.
- CPSC 5.3.8.3.1 – CPSC recommends that belt swing seats should be designed to accommodate no more than one user at any time. While the Konnection Swing is a single axis swing, it is clearly not a belt seat.
- CPSC 2.3.1 – CPSC says that swings intended for more than one user are not recommended because their greater mass, as compared to single occupancy swings, presents a risk of impact injury.
  - The ASTM safety standard, F1487, was revised in 2011 to add maximum impact requirements for swings and the Konnection Swing has been tested and is compliant with ASTM impact requirements.
  - CPSC has written a letter stating that “the swing impact test in F1487-11 is a reasonable approach to address the concerns posed by unoccupied, heavy, multiple occupancy swings.”
- CPSC has always included an exemption to both recommendations listed above for tire swings, which are multiple occupancy swings that are suspended from a single pivot and permit swinging in any direction.
- CPSC also emphasizes that their Handbook provides recommendations, not requirements. If a jurisdiction adopts the Handbook's recommendations as mandatory requirements, that jurisdiction would need to determine how the requirements should be applied in any particular instance.

# BURKE GENERATIONS WARRANTY®

## The Longest and Strongest warranty in the industry

BCI Burke Company, LLC ("Burke") warrants that all standard products are warranted to be free from defects in materials and workmanship, under normal use and service, for a period of one (1) year from the date of shipment.

## We stand behind our products. In addition, the following products are warranted, under normal use and service from the date of shipment as follows:

- One Hundred (100) Year Limited Warranty on aluminum and steel upright posts (including Intensity®, Synergy™, Nucleus®, Voltage®, Little Buddies®, ELEVATE®, ACTIVATE®, INVIGORATE™) against structural failure due to corrosion, deterioration or workmanship.
- One Hundred (100) Year Limited Warranty on KoreConnect® clamps against structural failure due to corrosion, deterioration or workmanship.
- One Hundred (100) Year Limited Warranty on Hardware (nuts, bolts, washers)
- One Hundred (100) Year Limited Warranty on bolt-through fastening and clamp systems (Synergy™, Intensity®, Nucleus®, Voltage®, Little Buddies®, ELEVATE®).
- Twenty-Five (25) Year Limited Warranty on spring assemblies and aluminum cast animals.
- Fifteen (15) Year Limited Warranty on structure platforms and decks, metal roofs, table tops, bench tops, railings and barriers against structural failure due to materials or workmanship.
- Fifteen (15) Year Limited Warranty on all plastic components including StoneBorders against structural failure due to materials or workmanship.
- Ten (10) Year Limited Warranty on ShadePlay Canopies fabric, threads, and cables against degradation, cracking or material breakdown resulting from ultra-violet exposure, natural deterioration or manufacturing defects. This warranty is limited to the design loads as stated in the specifications.
- Ten (10) Year Limited Warranty on NaturePlay® Boulders and GFRG products against structural failure due to natural deterioration or workmanship. Natural wear, which may occur with any concrete product with age, is excluded from this warranty.
- Ten (10) Year Limited Warranty on Full Color Custom Signage against manufacturing defects that cause delamination or degradation of the sign. Full Color Custom Signs also carry a two (2) year warranty against premature fading of the print and graphics on the signs.
- Five (5) Year Limited Warranty on Intensity® and RopeVenture® cables and LEVEL X® flex bridge against premature wear due to natural deterioration or manufacturing defects. Determination of premature wear will be at the manufacturer's discretion.
- Five (5) Year Limited Warranty on moving parts, including swing components, against structural failure due to materials or workmanship.
- Five (5) Year Limited Warranty on PlayEnsemble® cables and mallets against defects in materials and workmanship.
- Three (3) Year Limited Warranty on electronic panel speakers, sound chips and circuit boards against electronic failure caused by manufacturing defects.

The warranty stated above is valid only if the equipment is erected in conformity with the layout plan and/or installation instructions furnished by BCI Burke Company, LLC using approved parts; have been maintained and inspected in accordance with BCI Burke Company, LLC instructions. Burke's liability and your exclusive remedy hereunder will be limited to repair or replacement of those parts found in Burke's reasonable judgment to be defective. Any claim made within the above stated warranty periods must be made promptly after discovery of the defect. A part is covered only for the original warranty period of the applicable part. Replacement parts carry the applicable warranty from the date of shipment of the replacement from Burke. After the expiration of the warranty period, you must pay for all parts, transportation and service charges.

Burke reserves the right to accept or reject any claim in whole or in part. Burke will not accept the return of any product without its prior written approval. Burke will assume transportation charges for shipment of the returned product if it is returned in strict compliance with Burke's written instructions.

**THE FOREGOING WARRANTIES ARE EXCLUSIVE AND IN LIEU OF ANY OTHER WARRANTY, EXPRESS OR IMPLIED, INCLUDING BUT NOT LIMITED TO ANY IMPLIED WARRANTY OR MERCHANTABILITY OR FITNESS FOR A PARTICULAR PURPOSE. IF THE FOREGOING DISCLAIMER OF ADDITIONAL WARRANTIES IS NOT GIVEN FULL FORCE AND EFFECT, ANY RESULTING ADDITIONAL WARRANTY SHALL BE LIMITED IN DURATION TO THE EXPRESS WARRANTIES AND BE OTHERWISE SUBJECT TO AND LIMITED BY THE TERMS OF BURKE'S PRODUCT WARRANTY. SOME STATES DO NOT ALLOW THE EXCLUSION OF CERTAIN IMPLIED WARRANTIES, SO THE ABOVE LIMITATION MAY NOT APPLY TO YOU.**

**Warranty Exclusions:** The above stated warranties do not cover: "cosmetic" defects, such as scratches, dents, marring, or fading; damage due to incorrect installation, vandalism, misuse, accident, wear and tear from normal use, exposure to extreme weather, immersion in salt or chlorine water, unauthorized repair or modification, abnormal use, lack of maintenance, or other cause not within Burke's control; and

**Limitation of Remedies:** Burke is not liable for consequential or incidental damages, including but not limited to labor costs or lost profits resulting from the use of or inability to use the products or from the products being incorporated in or becoming a component of any other product. If, after a reasonable number of repeated efforts, Burke is unable to repair or replace a defective or nonconforming product, Burke shall have the option to accept return of the product, or part thereof, if such does not substantially impair its value, and return the purchase price as the buyer's entire and exclusive remedy. Without limiting the generality of the foregoing, Burke will not be responsible for labor costs involved in the removal of products or the installation of replacement products. Some states do not allow the exclusion of incidental damages, so the above exclusion may not apply to you.

The environment near a saltwater coast can be extremely corrosive. Some corrosion and/or deterioration is considered "normal wear" in this environment. Product installed within 500 yards of a saltwater shoreline will only be covered for half the period of the standard product warranty, up to a maximum of five years, for defects caused by corrosion. Products installed in direct contact with saltwater or that are subjected to salt spray are not covered by the standard warranty for any defects caused by corrosion.

Contact your local Burke Representative for warranty information regarding Burke Turf® and Burke Tile products.

### Terms of Sale

**Pricing:** Prices published in this catalog are in USD, are approximate and do not include shipping & handling, surfacing, installation nor applicable taxes. All prices are subject to change without notice. Contact your Burke representative for current pricing. Payments are to be made in USD.

**Weights:** Weights are approximate and may vary with actual orders.

**Installation:** All equipment is shipped unassembled. For a list of factory-certified installers in your area, please contact your Burke representative.

**Specifications:** Product specifications in this catalog were correct at the time of publication. However, product improvements are ongoing at Burke, and we reserve the right to change or discontinue specifications without notice.

**Loss or Damage in Transit:** A signed bill of lading is our receipt from a carrier that our shipment to you was complete and in good condition upon arrival. Before you sign, please check the Bill of lading carefully when the shipment arrives to make sure nothing is missing and there are no damages. Once the shipment leaves our plant, we are no longer responsible for any damage, loss or shortage.

For more information regarding the warranty, call Customer Service at 920-921-9220 or 1-800-356-2070.

01/2022

BCIBURKE.COM

**Burke**

800.266.1250