

## REQUEST FOR BOARD ACTION

### HENDERSON COUNTY BOARD OF COMMISSIONERS

MEETING DATE: January 5, 2009

SUBJECT: Petitions for addition to State Road system.

ATTACHMENTS: (1) Petition and map for Crab Creek Meadows Subdivision.  
(2) Petition and map for Kingdom Pl.  
(3) Petition and map for Wickham Way  
(4) Petition and map for Circle Top Dr  
(5) Petition and map for Peaceful View Estates  
(6) Petition and map for Streamside Dr  
(7) Petition and map for Roasted Chestnut Trl

SUMMARY OF REQUEST: Recommend approval of the attached petitions. It has been the practice of this Board to accept road petitions and forward them to NC Department of Transportation for their review. It has also been the practice of the Board not to ask NCDOT to change the priority for roads on the paving priority list.

#### BOARD ACTION REQUESTED:

Recommend approving petitions and forwarding to NCDOT

Suggested Motion: I move that the Board approve the petitions and forward them to NCDOT for action.

North Carolina Department of Transportation  
Division of Highways  
Petition for Road Addition

NOV 13 2003

**ROADWAY INFORMATION:** (Please Print/Type)

County: HENDERSON Road Name: CURTIS DRIVE  
(Please list additional street names and lengths on the back of this form.)

Subdivision Name: (Pinnickal view) CRAB CREEK MEADOWS Length (miles): 0.02  
Number of occupied homes having street frontage: 8 Located (miles): 1/4  
miles N ☐ S ☐ E ☐ W ☒ of the intersection of Route CRAB CREEK 1127 and Route 1196  
(Check one) (SR, NC, US) (SR, NC, US)

We, the undersigned, being property owners and/or developers of CRAB CREEK MEADOWS in HENDERSON County, do hereby request the Division of Highways to add the above described road.

**CONTACT PERSON:** Name and Address of First Petitioner. (Please Print/Type)

Name: JOHN W CHERRY Phone Number: 828-693-0232  
910-425-0222(c)  
Street Address: 7 CURTIS DRIVE  
Mailing Address: 7 CURTIS DR HENDERSONVILLE NC 28739

**PROPERTY OWNERS**

Name

Mailing Address

Telephone

Clifford Orr 272 Golfview Ct SW Supply NC 28762 910 842 1374

John W Cherry 7 CURTIS DR Hendersonville NC 828-693-0232

Ernest O. Wright 101 Regency Loop DR 828-697-9915

North Carolina Department of Transportation  
Division of Highways  
Petition for Road Addition



NOV 13 2003

**ROADWAY INFORMATION:** (Please Print/Type)

County: Henderson Road Name: CONGER  
(Please list additional street names and lengths on the back of this form.)

Subdivision Name: (Pinnacle View)  
CRAB Creek MEADOWS Length (miles): 0.01

Number of occupied homes having street frontage: 7 Located (miles): 1/4 mile

miles N ☐ S ☐ E ☐ W ☒ of the intersection of Route CRAB Creek  
(Check one) 1127 (SR, NC, US) and Route 1196 Evans  
(SR, NC, US)

We, the undersigned, being property owners and/or developers of CRAB Creek MEADOWS  
Henderson County, do hereby request the Division of Highways to add the above described road.

**CONTACT PERSON:** Name and Address of First Petitioner. (Please Print/Type)

Name: JOHN W CHERRY Phone Number: 828 693 0232  
Street Address: 7 CURTIS DRIVE  
Mailing Address: 7 CURTIS DRIVE HENDERSONVILLE NC 28739

**PROPERTY OWNERS**

Name	Mailing Address	Telephone
Carline & Martin Greedy	18 Conger Dr. H'ville, 28739	828 697 2080
Kym Morgan	18 Conger H'ville 28739	(828) 696-3371
Amber Hunter	14 Conger Dr Aville 28739	828-697-6594
Robert Morgan	811 N. LAKESIDE DR. 28739	828 692-9066
Ashley Henderson	16 Conger Dr. H'ville 28739	828-698-6626
Neil Patterson	8 CONGER DRIVE H'VILLE N.C. 28739	828-698-7787
Carol Patterson	" " " " " "	828-698-7787

North Carolina Department of Transportation  
Division of Highways  
Petition for Road Addition

NOV 13 2006

**ROADWAY INFORMATION:** (Please Print/Type)

County: \_\_\_\_\_ Road Name: \_\_\_\_\_  
(Please list additional street names and lengths on the back of this form.)

Subdivision Name: \_\_\_\_\_ Length (miles): \_\_\_\_\_

Number of occupied homes having street frontage: \_\_\_\_\_ Located (miles): \_\_\_\_\_

miles N ☐ S ☐ E ☐ W ☐ of the intersection of Route \_\_\_\_\_ and Route \_\_\_\_\_  
(Check one) (SR, NC, US) (SR, NC, US)

We, the undersigned, being property owners and/or developers of \_\_\_\_\_ in  
\_\_\_\_\_ County, do hereby request the Division of Highways to add the above described road.

**CONTACT PERSON:** Name and Address of First Petitioner. (Please Print/Type)

Name: \_\_\_\_\_ Phone Number: 694-1569

Street Address: \_\_\_\_\_

Mailing Address: \_\_\_\_\_

**PROPERTY OWNERS**

Name	Mailing Address	Telephone
Paul + DARci AKA "Ryan" O'Neill	3 Curtis Dr Hendersonville, NC 28739	828 694-1569
JAMES D. d HELEN M. BAILEY	13 CURTIS DR. H'VILLE, N.C. 28139	813-9575
Peggy Barricks	11 Curtis Dr, Hendersonville, NC 28739	693-0468
William P Ashley Hartshorn	15 Curtis Dr. Hendersonville, NC 28739	808-5542
Lorena Gussey	12 Curtis Dr. Hendersonville, N.C. 28739	828 8636

North Carolina Department of Transportation  
Division of Highways  
Petition for Road Addition

NOV 13 2006

**ROADWAY INFORMATION:** (Please Print/Type)

County: \_\_\_\_\_ Road Name: \_\_\_\_\_  
(Please list additional street names and lengths on the back of this form.)

Subdivision Name: \_\_\_\_\_ Length (miles): \_\_\_\_\_

Number of occupied homes having street frontage: \_\_\_\_\_ Located (miles): \_\_\_\_\_

miles N ☐ S ☐ E ☐ W ☐ of the intersection of Route \_\_\_\_\_ and Route \_\_\_\_\_  
(Check one) (SR, NC, US) (SR, NC, US)

We, the undersigned, being property owners and/or developers of \_\_\_\_\_ in  
\_\_\_\_\_ County, do hereby request the Division of Highways to add the above described road.

**CONTACT PERSON:** Name and Address of First Petitioner. (Please Print/Type)

Name: \_\_\_\_\_ Phone Number: \_\_\_\_\_

Street Address: \_\_\_\_\_

Mailing Address: \_\_\_\_\_

**PROPERTY OWNERS**

<u>Name</u>	<u>Mailing Address</u>	<u>Telephone</u>
KRAIG & VALORIE HARGRAVES	6 CONGER DRIVE	692-8075
Steve & Jan Orr	1 Curtis Dr.	828-692-7010
April M Banner	4 Conger Dr	828-697-2179
Larry & Perryann Kivon	5 Curtis Dr.	828-698-1145

North Carolina Department of Transportation  
Division of Highways  
Petition for Road Addition

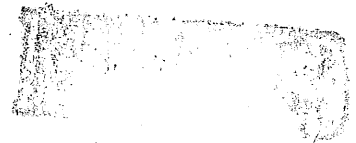

NOV 13 2003

**ROADWAY INFORMATION:** (Please Print/Type)

County: \_\_\_\_\_ Road Name: \_\_\_\_\_  
(Please list additional street names and lengths on the back of this form.)

Subdivision Name: \_\_\_\_\_ Length (miles): \_\_\_\_\_

Number of occupied homes having street frontage: \_\_\_\_\_ Located (miles): \_\_\_\_\_

miles N ☐ S ☐ E ☐ W ☐ of the intersection of Route \_\_\_\_\_ and Route \_\_\_\_\_  
(Check one) (SR, NC, US) (SR, NC, US)

We, the undersigned, being property owners and/or developers of \_\_\_\_\_ in \_\_\_\_\_ County, do hereby request the Division of Highways to add the above described road.

**CONTACT PERSON:** Name and Address of First Petitioner. (Please Print/Type)

Name: \_\_\_\_\_ Phone Number: \_\_\_\_\_

Street Address: \_\_\_\_\_

Mailing Address: \_\_\_\_\_

**PROPERTY OWNERS**

Name

Mailing Address

Telephone

*Ken Adams* *128 Warren Lane Brevard NC* *884-7108*

North Carolina Department of Transportation  
Division of Highways  
Petition for Road Addition

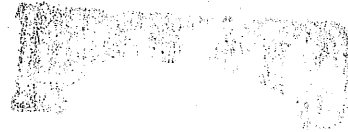

NOV 1 2 2006

**ROADWAY INFORMATION:** (Please Print/Type)

COMMISSION DISTRICT 1

County: \_\_\_\_\_ Road Name: \_\_\_\_\_  
(Please list additional street names and lengths on the back of this form.)

Subdivision Name: \_\_\_\_\_ Length (miles): \_\_\_\_\_

Number of occupied homes having street frontage: \_\_\_\_\_ Located (miles): \_\_\_\_\_

miles N ☐ S ☐ E ☐ W ☐ of the intersection of Route \_\_\_\_\_ and Route \_\_\_\_\_  
(Check one) (SR, NC, US) (SR, NC, US)

We, the undersigned, being property owners and/or developers of \_\_\_\_\_ in \_\_\_\_\_ County, do hereby request the Division of Highways to add the above described road.

**CONTACT PERSON:** Name and Address of First Petitioner. (Please Print/Type)

Name: \_\_\_\_\_ Phone Number: \_\_\_\_\_

Street Address: \_\_\_\_\_

Mailing Address: \_\_\_\_\_

**PROPERTY OWNERS**

Name

Mailing Address

Telephone

SHANE ROARK 2235 Floral Dr. Boulder, CO 80304 303-447-9325

*Shane Roark*

INSTRUCTIONS FOR COMPLETING PETITION:

1. Complete Information Section
2. Identify Contact Person (This person serves as spokesperson for petitioner(s)).
3. Attach four (4) copies of recorded subdivision plat or property deeds, which refer to candidate road.
4. Adjoining property owners and/or the developer may submit a petition. Subdivision roads with prior NCDOT review and approval only require the developer's signature.
5. If submitted by the developer, encroachment agreements from all utilities located within the right of way shall be submitted with the petition for Road addition. However, construction plans may not be required at this time.
6. Submit to District Engineer's Office.

**FOR NCDOT USE ONLY:** Please check the appropriate block

☐ Rural Road    ☐ Subdivision platted prior to October 1, 1975    ☐ Subdivision platted after September 30, 1975

**REQUIREMENTS FOR ADDITION**

If this road meets the requirements necessary for addition, we agree to grant the Department of Transportation a right-of-way of the necessary width to construct the road to the minimum construction standards of the NCDOT. The right-of-way will extend the entire length of the road that is requested to be added to the state maintained system and will include the necessary areas outside of the right-of-way for cut and fill slopes and drainage. Also, we agree to dedicate additional right-of-way at intersections for sight distance and design purposes and execute said right-of-way agreement forms that will be submitted to us by representatives of the NCDOT. The right-of-way shall be cleared at no expense to the NCDOT, which includes the removal of utilities, fences, other obstructions, etc.

General Statute 136-102.6 (see page 29 for Statute) states that any subdivision recorded on or after October 1, 1975, must be built in accordance with NCDOT standards in order to be eligible for addition to the State Road System.

<u>ROAD NAME</u>	<u>HOMES</u>	<u>LENGTH</u>	<u>ROAD NAME</u>	<u>HOMES</u>	<u>LENGTH</u>
CURTIS DRIVE	8	1000 Feet			
CONGER DRIVE	7	700 Feet			



# STATE ROAD PETITION REQUEST

CRAB CREEK MEADOWS SUBDIVISION

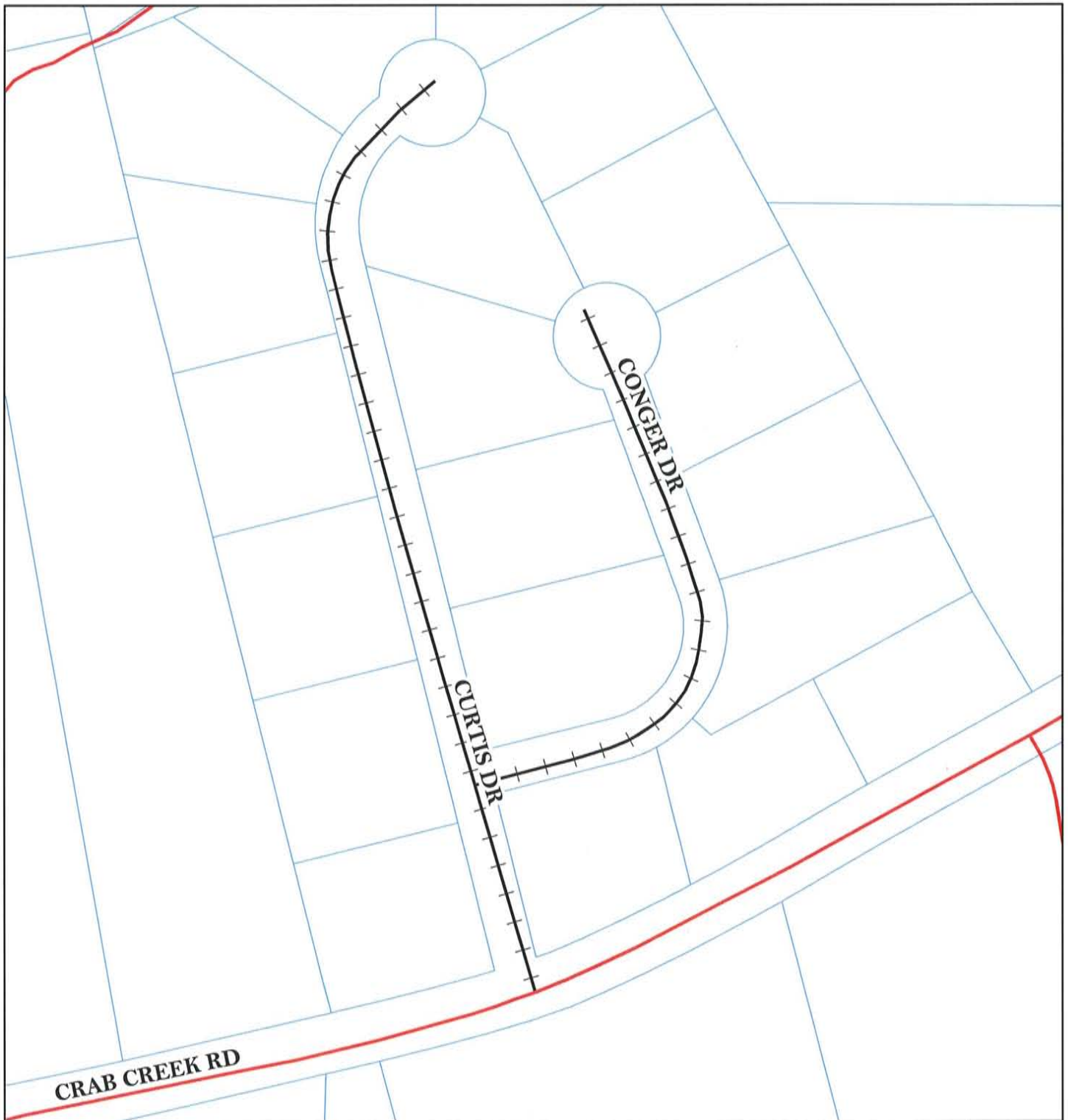

## Legend

- COLLECTOR
- LOCAL ROAD
- + Proposed addition to state maintenance



North Carolina Department of Transportation  
Division of Highways  
Petition for Road Addition

**ROADWAY INFORMATION:** (Please Print/Type)

County: Henderson Road Name: Kingdom Place  
(Please list additional street names and lengths on the back of this form.)

Subdivision Name: \_\_\_\_\_ Length (miles): 0.6 miles (est)  
~~1 mile~~

Number of occupied homes having street frontage: \_\_\_\_\_ Location \_\_\_\_\_

miles miles N ☐ S ☐ E ☐ W ☐ of the intersection of Route \_\_\_\_\_ and Route \_\_\_\_\_  
(Check one) (SR, NC, US) (SR, NC, US)

We, the undersigned, being property owners and/or developers of Kingdom Place in  
Henderson County, do hereby request the Division of Highways to add the above described road.

**CONTACT PERSON:** Name and Address of First Petitioner. (Please Print/Type)

Name: John Motes Phone Number: 828-693-0451

Street Address: 417 Kingdom Pl Zirconia NC 28790

Mailing Address: \_\_\_\_\_

**PROPERTY OWNERS**

Name	Mailing Address	Telephone
✓ John Motes	417 Kingdom Pl Zirconia NC 28790	828-693-0451
✓ Robert E. Lyda Jr	PO Box 5 Zirconia NC 28790	828-692-6018
Stone Connection	417 Kingdom Pl Zirconia NC 28790	692-0451
✓ Linda H. Davis	55 English Ivy Lane	692-7632
✓ Stuart McCall	32 Whispering Winds Ln	692-7426
Michael Newm	75 Whispering Winds Ln	692-2706
Calvin Dainjer	122 English Ivy Lane Zirconia	697-7945
✓ Charles A. Williams	494 Kingdom Place Zirconia NC	693-6753

## Property Owners

**Name**

**Mailing Address**

Telephone

Rodney L

HOLLY F ROBINSON 633 Kingdom PL ZIRCONIA, NC 28790 828-329-7995

JAMES & PAT ASTLE 89 Rising Mist Lane " " " 828-808-5370

✓ Burt Mooney + BJ Parsons 114 Blueberry Ridge Ln, Zirconia NC 28790 828-692-4999

✓ Ronald Oglet 174 Rising Mist Lane Zirconia N.C. 28790 8286935130

Evan & Teresa Stone 51 Rising Mist Ln. Zirconia 28790 828 698-4696

✓ Lisa P. Jones 68 Kingdom Place, Zirconia, NC 28790 243-1542 (825)

✓ Ralph Kunkel 212 Kinston Place Zirconia NC 28790 02436245

Philby Kuykendall 182 Kinderhook Place Zircara, IL 28790 - 828-577-0854



## Property Owners

Name

### Mailing Address

Telephone

Rodney

HOLLY F Robinson 633 Kingsdom PL ZIRCONIA, NC 28790 828-329-7995

JAMES & PAT ASTLE 89 Rising Mist Lane " " " 828-808-5370

Burt Mooney + BJ Parsons 114 Blueberry Ridge Ln, Zirconia NC 28790 828-692-4999

Ronald Ogilvie 174 Rising Mist Lane Zirconia N.C. 28790 8286935130

Evan & Teresa Stone 51 Rising Mist Ln. Zirconia 28790 828 498-4698

✓ Tim + Lynda Lykes 506 Kingdom Place Zirconia NC 28796  
→ Simithy's physical address of ownership  
'Lykes' mailing address: 17326-21st Ave SW, Burien, WA 98166

This image shows a single sheet of white paper with horizontal blue or grey ruling lines. The lines are evenly spaced and run across the width of the page. There is no handwriting or other markings on the paper.

## Property Owners

<u>Name</u>	<u>Mailing Address</u>	<u>Telephone</u>
✓ Rodney & Robinson	633 Kingdom PL Zirconia, NC 28790	828-329-7995
James & Patricia	89 Rising Mist Lane " " "	828-808-5370
Burt Mooney & BJ Parsons	114 Blueberry Ridge Ln, Zirconia NC 28790	828-692-4999
Ronald Oglet	174 Rising Mist Lane Zirconia N.C.	28790 828-693-5130
Ever & Teresa Stone	51 Rising Mist Ln. Zirconia	28790 828-698-4698
✓ Mike & Coni Barnett	275 Kingdom Pl Zirconia, NC 28790	

## Property Owners

Name

### Mailing Address

Telephone

✓ Frank Bell RD. Box 8, Tuxedo, NE 28784 328 693-7656  
✓ Walter Mace 1127 Shepherd St Henderson, NE 28792

**INSTRUCTIONS FOR COMPLETING PETITION:**

1. Complete Information Section
2. Identify Contact Person (This person serves as spokesperson for petitioner(s)).
3. Attach four (4) copies of recorded subdivision plat or property deeds, which refer to candidate road.
4. Adjoining property owners and/or the developer may submit a petition. Subdivision roads with prior NCDOT review and approval only require the developer's signature.
5. If submitted by the developer, encroachment agreements from all utilities located within the right of way shall be submitted with the petition for Road addition. However, construction plans may not be required at this time.
6. Submit to District Engineer's Office.

**FOR NCDOT USE ONLY:** Please check the appropriate block  
☐ Rural Road    ☐ Subdivision platted prior to October 1, 1975    ☐ Subdivision platted after October 1, 1975

☐ Subdivision platted prior to October 1, 1975☐ Subdivision platted after October 1, 1975

## REQUIREMENTS FOR ADDITION

If this road meets the requirements necessary for addition, we agree to grant the Department of Transportation a right-of-way of the necessary width to construct the road to the minimum construction standards of the NCDOT. The right-of-way will extend the entire length of the road that is requested to be added to the state maintained system and will include the necessary areas outside of the right-of-way for cut and fill slopes and drainage. Also, we agree to dedicate additional right-of-way at intersections for sight distance and design purposes and execute said right-of-way agreement forms that will be submitted to us by representatives of the NCDOT. The right-of-way shall be cleared at no expense to the NCDOT, which includes the removal of utilities, fences, other obstructions, etc.

General Statute 136-102.6 (see page 29 for Statute) states that any subdivision recorded on or after October 1, 1975, must be built in accordance with NCDOT standards in order to be eligible for addition to the State Road System.

[illegible]

# STATE ROAD PETITION REQUEST

KINGDOM PL

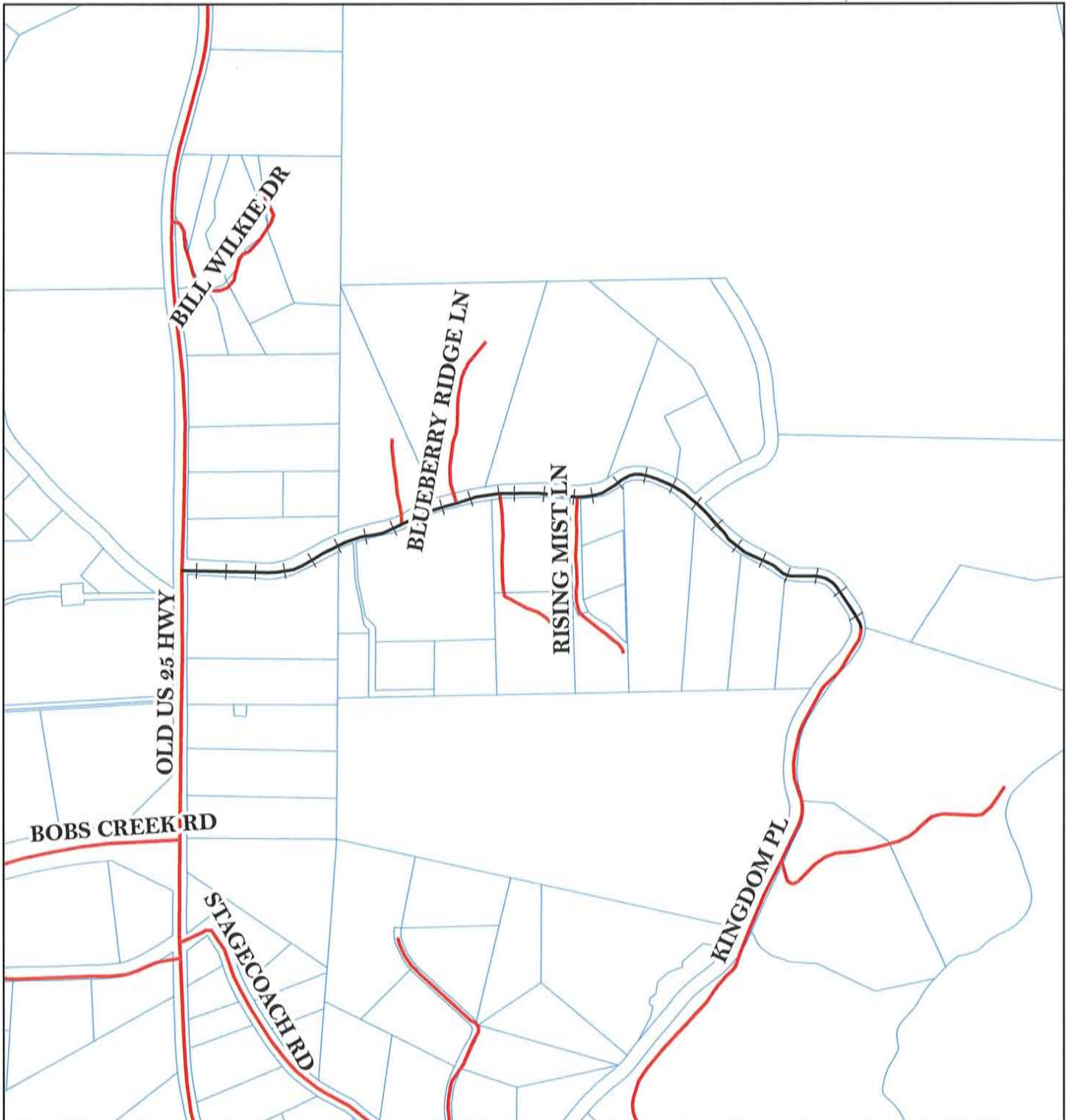

## Legend

- COLLECTOR
- LOCAL ROAD
- Proposed addition to state maintenance







JAN 23 2008

North Carolina Department of Transportation  
Division of Highways  
Petition for Road Addition

NCDOT

DIVISION 14 DISTRICT 11

Prepared: 19 Jan 2008

**ROADWAY INFORMATION:** (Please Print/Type)

County: Henderson Road Name: WICKHAM WAY  
(Please list additional street names and lengths on the back of this form.)

Subdivision Name: HAWTHORN HILLS, PHASE II Length (miles): .092

Number of occupied homes having street frontage: 4 Located (miles): less than 1/10 mile

miles N ☒ S ☐ E ☐ W ☐ of the intersection of Route SR 2271 and Route SR 2285, and less than 1 mile north of the intersection of SR 2271 and US 64 W.  
(Check one) (SR, NC, US) (SR, NC, US)

We, the undersigned, being property owners and/or developers of HAWTHORN HILLS, PHASE II in HENDERSON County, do hereby request the Division of Highways to add the above described road.

**CONTACT PERSON:** Name and Address of First Petitioner. (Please Print/Type)

Name: DAVID F. BAKER, Project Officer Phone Number: 828-891-7528

Street Address: 5 Riding Gate Road, Hendersonville NC 28791

Mailing Address: (Same) David Baker

**PROPERTY OWNERS**NameMailing AddressTelephone

Lot 5  
15-16 Harold & Mary Joy Hatch 7 WICKHAM WAY, Hendersonville, N.C. 828-891-4191  
Signatures: [Signature] & [Signature] 828-891-4191  
17 Bruce & Patti Griffith 10 WICKHAM WAY, Hendersonville, N.C. 828-891-5215  
Signatures: [Signature] & [Signature]  
19-200 George & Susan Buttermore 4 WICKHAM WAY, Hendersonville, N.C. 828-891-6252  
Signatures: [Signature] & [Signature]  
14 Kenneth & Adrian Benjamin 3 WICKHAM WAY, Hendersonville, N.C. 828-891-5739  
Signatures: [Signature] & [Signature]

**INSTRUCTIONS FOR COMPLETING PETITION:**

1. Complete Information Section
2. Identify Contact Person (This person serves as spokesperson for petitioner(s)).
3. Attach four (4) copies of recorded subdivision plat or property deeds, which refer to candidate road.
4. Adjoining property owners and/or the developer may submit a petition. Subdivision roads with prior NCDOT review and approval only require the developer's signature.
5. If submitted by the developer, encroachment agreements from all utilities located within the right of way shall be submitted with the petition for Road addition. However, construction plans may not be required at this time.
6. Submit to District Engineer's Office.

**FOR NCDOT USE ONLY:** Please check the appropriate block☐ Rural Road    ☐ Subdivision platted prior to October 1, 1975    ☐ Subdivision platted after September 30, 1975**REQUIREMENTS FOR ADDITION**

If this road meets the requirements necessary for addition, we agree to grant the Department of Transportation a right-of-way of the necessary width to construct the road to the minimum construction standards of the NCDOT. The right-of-way will extend the entire length of the road that is requested to be added to the state maintained system and will include the necessary areas outside of the right-of-way for cut and fill slopes and drainage. Also, we agree to dedicate additional right-of-way at intersections for sight distance and design purposes and execute said right-of-way agreement forms that will be submitted to us by representatives of the NCDOT. The right-of-way shall be cleared at no expense to the NCDOT, which includes the removal of utilities, fences, other obstructions, etc.

General Statute 136-102.6 (see page 29 for Statute) states that any subdivision recorded on or after October 1, 1975, must be built in accordance with NCDOT standards in order to be eligible for addition to the State Road System.

<u>ROAD NAME</u>	<u>HOMES</u>	<u>LENGTH</u>	<u>ROAD NAME</u>	<u>HOMES</u>	<u>LENGTH</u>
WICKHAM Way	4	.892 mile			

# STATE ROAD PETITION REQUEST

WICKHAM WAY

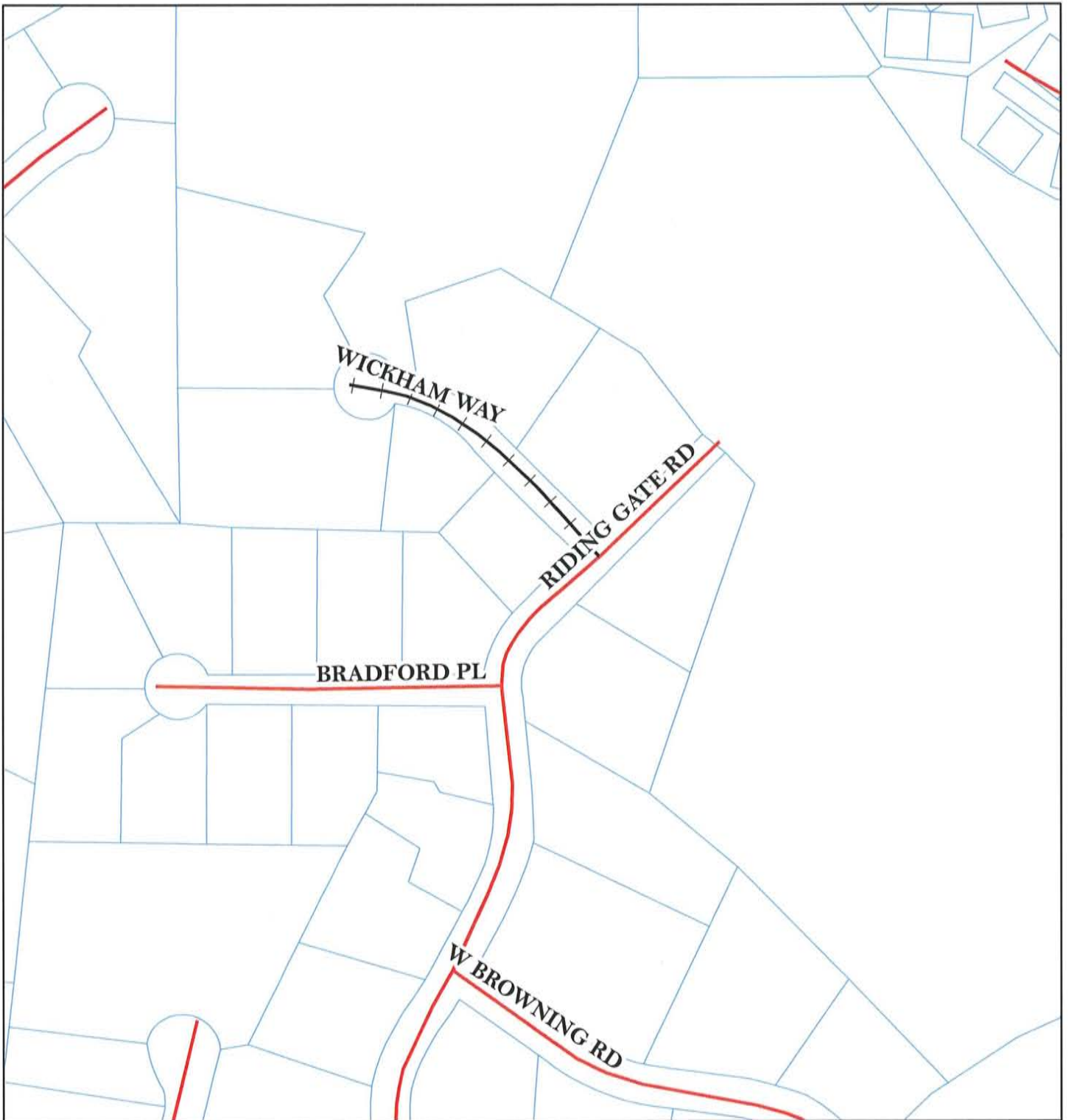

## Legend

- COLLECTOR
- LOCAL ROAD
- Proposed addition to state maintenance



North Carolina Department of Transportation  
Division of Highways  
Petition for Road Addition

AUG 13 2006

**ROADWAY INFORMATION:** (Please Print/Type)

County: HENDERSON Road Name: CIRCLE TOP DRIVE  
(Please list additional street names and lengths on the back of this form.)

Subdivision Name: MT. VALLEY Length (miles): .20

Number of occupied homes having street frontage: 10 Located (miles): .10-

miles N ☒ S ☐ E ☐ W ☐ of the intersection of Route 2121 and Route 2148  
(Check one) (SR, NC, US) (SR, NC, US)

We, the undersigned, being property owners and/or developers of CIRCLE TOP DRIVE in  
HENDERSON County, do hereby request the Division of Highways to add the above described road.

**CONTACT PERSON:** Name and Address of First Petitioner. (Please Print/Type)

Name: LAWRENCE M. SULLIVAN Phone Number: 828-891-9052

Street Address: 300 CIRCLE TOP DRIVE

Mailing Address: HENDERSONVILLE, NC. 28739

**PROPERTY OWNERS**

Name	Mailing Address	Telephone
William H. Weller	238 Circle Top DR	(828) 890-0426
Mary D. Weller	" "	" "
John B. McEverett	248 Circle top DR	828-890-0735
Karl M. McEverett	248 CIRCLE TOP DR.	828-890-0735
Charles A. VanDell	156 Circle Top Dr	828-890-8117
John M. Sullivan	300 CIRCLE TOP DRIVE	828-891-9052
Laurena M. Sullivan	Lot 67	" " "
Robert M. Sullivan	Lot 71	561-642-8172

North Carolina Department of Transportation  
Division of Highways  
Petition for Road Addition

AUG 13 2003

**ROADWAY INFORMATION:** (Please Print/Type)

County: HENDERSON Road Name: CIRCLE TOP DRIVE  
(Please list additional street names and lengths on the back of this form.)

Subdivision Name: MT. VALLEY Length (miles): .20

Number of occupied homes having street frontage: 10 Located (miles): .10

miles N ☒ S ☐ E ☐ W ☐ of the intersection of Route 212 and Route 2148  
(Check one) (SR, NC, US) (SR, NC, US)

We, the undersigned, being property owners and/or developers of CIRCLE TOP DRIVE in HENDERSON County, do hereby request the Division of Highways to add the above described road.

**CONTACT PERSON:** Name and Address of First Petitioner. (Please Print/Type)

Name: LAWRENCE M. SULLIVAN Phone Number: 828-891-9052

Street Address: 300 CIRCLE TOP DRIVE

Mailing Address: HENDERSONVILLE, NC. 28739

**PROPERTY OWNERS**

Name	Mailing Address	Telephone
Ray & Lorraine (Levine)	182 Circle Top Dr.	828-891-7808
Grandchild (ALTER)	216 CIRCLE TOP DR.	cell-954-5580294
Grandchild (ALTER)	LOT 68 - CIRCLE TOP DR.	cell 954 445 8601
Michelle Langel (LANGEL)	190 Circle Top Dr.	828-891-8852
Ann L. Williamson (LERNER)	200 Circle TOP DR.	954 816-0025
ANN L. WILLIAMSON TRUST	297 Circle Top DR.	828 891-6250
Ann L. Williamson, Trustee		
Phinda Luce (Luce)	299 Circle Top Dr.	(828)891-9773
Phinda Luce (Luce)	" " " "	

**INSTRUCTIONS FOR COMPLETING PETITION:**

1. Complete Information Section
2. Identify Contact Person (This person serves as spokesperson for petitioner(s)).
3. Attach four (4) copies of recorded subdivision plat or property deeds, which refer to candidate road.
4. Adjoining property owners and/or the developer may submit a petition. Subdivision roads with prior NCDOT review and approval only require the developer's signature.
5. If submitted by the developer, encroachment agreements from all utilities located within the right of way shall be submitted with the petition for Road addition. However, construction plans may not be required at this time.
6. Submit to District Engineer's Office.

- INSTRUCTIONS FOR COMPLETING PETITION:**

  1. Complete Information Section
  2. Identify Contact Person (This person serves as spokesperson for petitioner(s)).
  3. Attach four (4) copies of recorded subdivision plat or property deeds, which refer to candidate road.
  4. Adjoining property owners and/or the developer may submit a petition. Subdivision roads with prior NCDOT review and approval only require the developer's signature.
  5. If submitted by the developer, encroachment agreements from all utilities located within the right of way shall be submitted with the petition for Road addition. However, construction plans may not be required at this time.
  6. Submit to District Engineer's Office.

**FOR NCDOT USE ONLY:** Please check the appropriate block  
☐ Rural Road    ☐ Subdivision platted prior to October 1, 1975    ☐ Subdivision platted after September 30, 1975

**FOR NCDOT USE ONLY:** Please check the appropriate block  
☐ Rural Road    ☐ Subdivision platted prior to October 1, 1975    ☐ Subdivision platted after September 30, 1975

### REQUIREMENTS FOR ADDITION

If this road meets the requirements necessary for addition, we agree to grant the Department of Transportation a right-of-way of the necessary width to construct the road to the minimum construction standards of the NCDOT. The right-of-way will extend the entire length of the road that is requested to be added to the state maintained system and will include the necessary areas outside of the right-of-way for cut and fill slopes and drainage. Also, we agree to dedicate additional right-of-way at intersections for sight distance and design purposes and execute said right-of-way agreement forms that will be submitted to us by representatives of the NCDOT. The right-of-way shall be cleared at no expense to the NCDOT, which includes the removal of utilities, fences, other obstructions, etc.

General Statute 136-102.6 (see page 29 for Statute) states that any subdivision recorded on or after October 1, 1975, must be built in accordance with NCDOT standards in order to be eligible for addition to the State Road System.

[illegible]

# STATE ROAD PETITION REQUEST

CIRCLE TOP DR

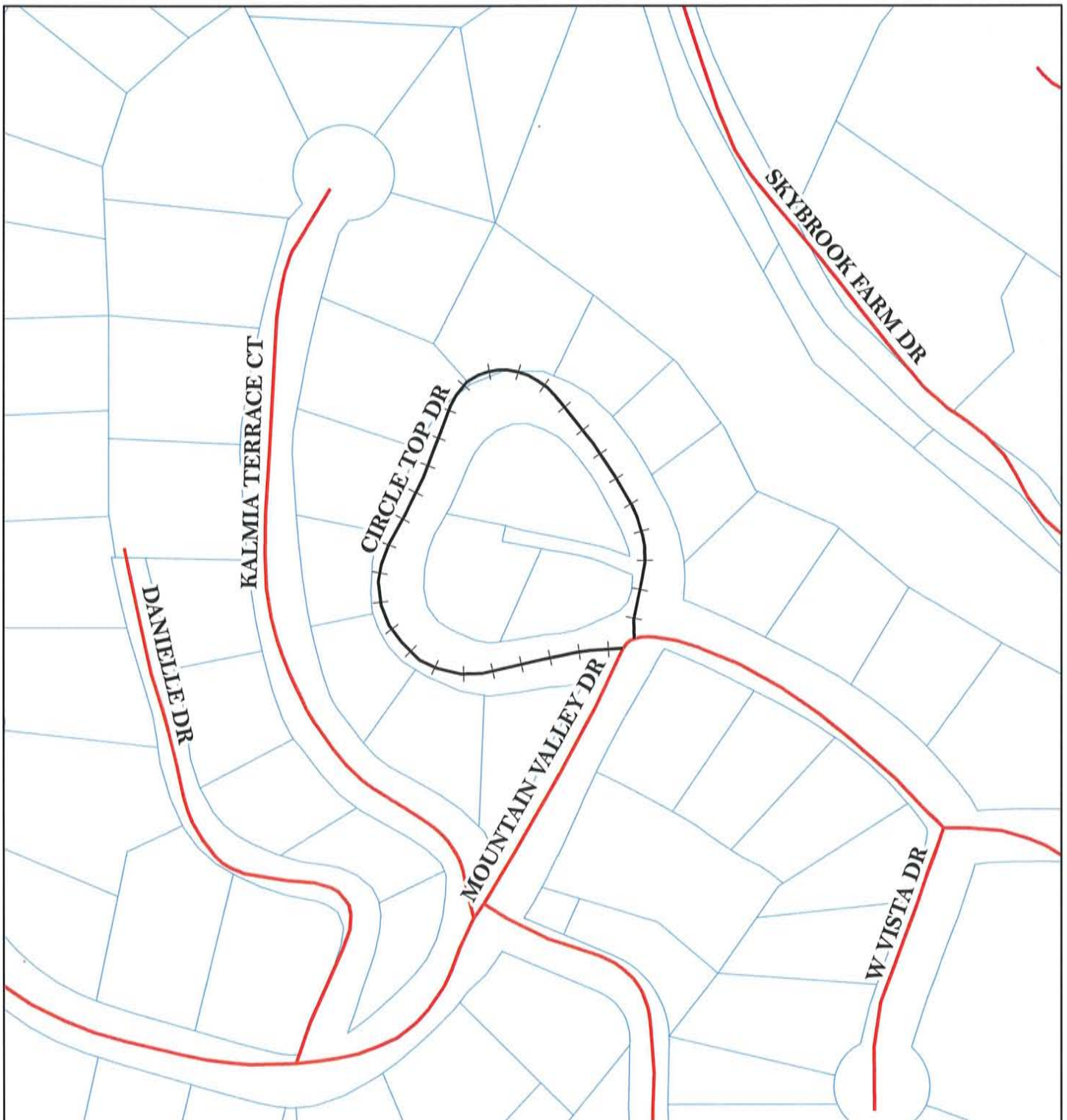

## Legend

- COLLECTOR
- LOCAL ROAD
- Proposed addition to state maintenance





**North Carolina Department of Transportation  
Division of Highways  
Petition for Road Addition**

**ROADWAY INFORMATION:** (Please Print/Type)

County: Henderson Road Name: Peaceful Orchard DR - Cleo Court  
(Please list additional street names and lengths on the back of this form.)

Subdivision Name: Peaceful View Estates Length (miles): \_\_\_\_\_

Number of occupied homes having street frontage: 13 . Location \_\_\_\_\_

miles miles N ☐ S ☐ E ☐ W ☐ of the intersection of Route \_\_\_\_\_ and Route \_\_\_\_\_  
(Check one) (SR, NC, US) (SR, NC, US)

We, the undersigned, being property owners and/or developers of Peaceful View Estates in Henderson County, do hereby request the Division of Highways to add the above described road.

**CONTACT PERSON:** Name and Address of First Petitioner. (Please Print/Type)

Name: \_\_\_\_\_ Phone Number: \_\_\_\_\_

Street Address: \_\_\_\_\_

Mailing Address: \_\_\_\_\_

**PROPERTY OWNERS**

Name	Mailing Address	Telephone
Gail FRANCOISE	279 STEPP MALL NASHVILLE NC	685-7445
Ronnie & Dawn Heatherly	132 Peaceful Orchard DR Hendersonville NC 28792	685-8473
Karen & Clifton Mervine	86 Peaceful Orchard Dr. Hendersonville, NC 28792	221-1329
Theresa & Criston Gaddy	32 Cleo Court Hendersonville NC 28792	808-0960
MAT & Chrissy Hochstetler	71 Cleo Ct Hendersonville, NC 28792	685-0108
PENNY GEFER	54 CLEO CT HENDERSONVILLE NC 28792	685-1485
Leon R & Dorcas S. Sutton	145 Peaceful Orchard Dr Hendersonville NC 272-0002	
Michael And Amanda JUSTAS	91 peaceful orchard drive, Hendersonville NC 28792	
BOB & BONNIE CHAYA	221 PEACEFUL ORCHARD DR, HENDERSONVILLE NC 28792	685-0617
Michael & Kristy Capps	181 Peaceful Orchard Dr Hendersonville N.C. 28792	243-2286
J. Robert & Norma Sutton	174 Peaceful Orchard Dr Hendersonville NC 28792	685-0776
Tim & Donna Godley	220 Peaceful Orchard Drive, Hendersonville NC 28792	685-3542



1. Complete Information Section
2. Identify Contact Person (This person serves as spokesperson for petitioner(s)).
3. Attach four (4) copies of recorded subdivision plat or property deeds, which refer to candidate road.
4. Adjoining property owners and/or the developer may submit a petition. Subdivision roads with prior NCDOT review and approval only require the developer's signature.
5. If submitted by the developer, encroachment agreements from all utilities located within the right of way shall be submitted with the petition for Road addition. However, construction plans may not be required at this time.
6. Submit to District Engineer's Office.

☐ Rural Road    ☐ Subdivision platted prior to October 1, 1975    ☐ Subdivision platted after October 1, 1975

If this road meets the requirements necessary for addition, we agree to grant the Department of Transportation a right-of-way of the necessary width to construct the road to the minimum construction standards of the NCDOT. The right-of-way will extend the entire length of the road that is requested to be added to the state maintained system and will include the necessary areas outside of the right-of-way for cut and fill slopes and drainage. Also, we agree to dedicate additional right-of-way at intersections for sight distance and design purposes and execute said right-of-way agreement forms that will be submitted to us by representatives of the NCDOT. The right-of-way shall be cleared at no expense to the NCDOT, which includes the removal of utilities, fences, other obstructions, etc.

[illegible]

# STATE ROAD PETITION REQUEST

PEACEFUL VIEW ESTATES

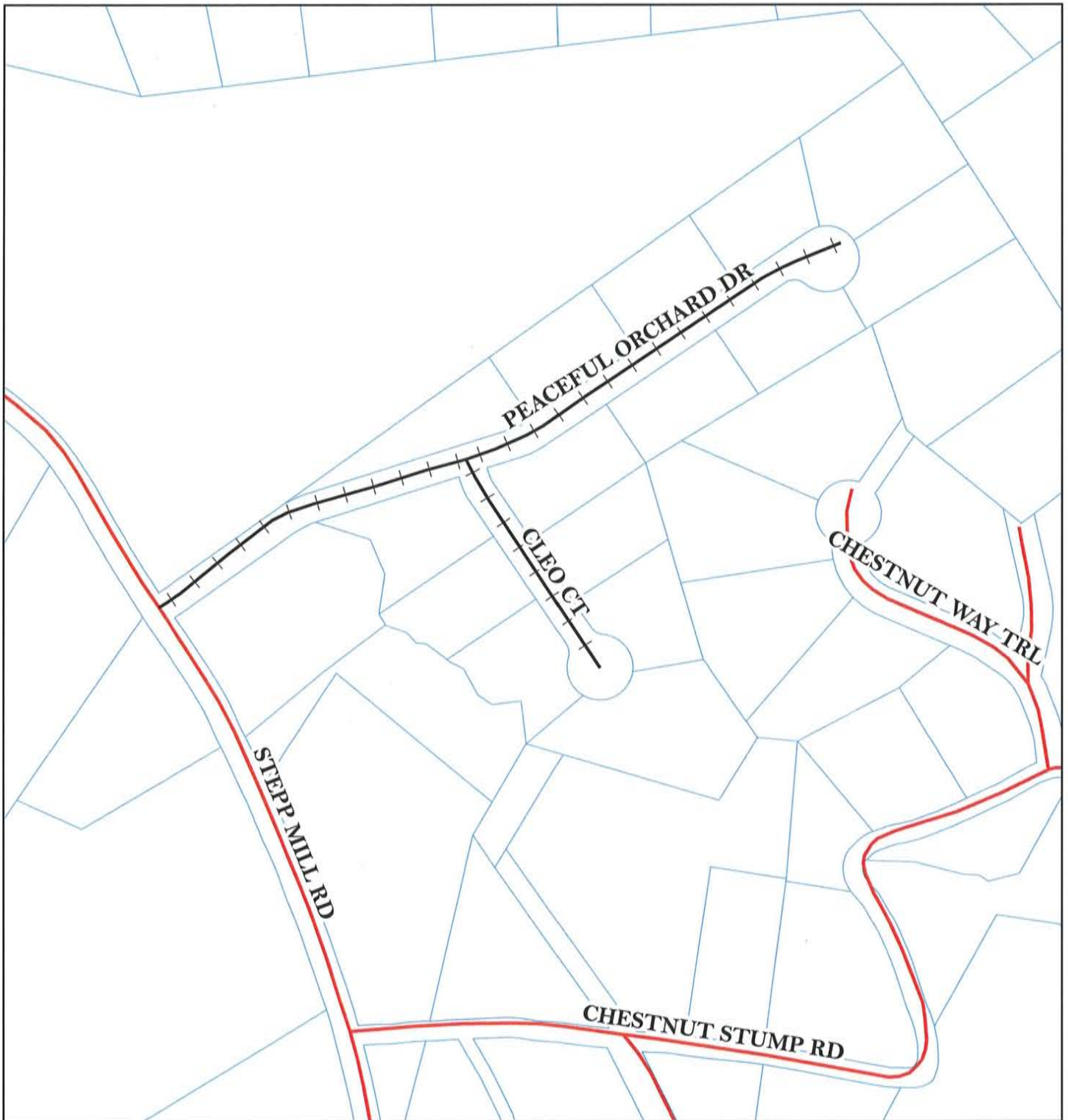

## Legend

- COLLECTOR
- LOCAL ROAD
- Proposed addition to state maintenance



NORTH CAROLINA DEPARTMENT OF TRANSPORTATION  
PETITION FOR ROAD ADDITION  
FORM SR-1 REVISED 1-99

ROADWAY INFORMATION: (Please Print)

County: HENDERSON Road Name: Streamside Drive  
(Please list additional street names and lengths on the back of this form.)

Subdivision Name: Timber Nook Length (miles): 438.42' = .083 miles

Number of occupied homes having street frontage: (4) occupied, (1) unoccupied, (1) to be built.

Location: .4 miles (N) S E W of the intersection of Route US 64 and Route SR 1452  
(Circle one) (SR, NC or US) (SR, NC or US)

We, the undersigned, being property owners and/or developer of Streamside Dr. in  
HENDERSON County, do hereby request the Division of Highways to add the above described road.

CONTACT PERSON: Name and Address of First Petitioner. (Please Print)

Name: Thomas L. Hanna Phone Number: 828-696-4374  
727-729-5493

Street Address: 64 Streamside Dr., Hendersonville, NC 28791

Mailing Address: 1560 Sandy Ln., Clearwater, FL 33755

Lot #	NAME	PROPERTY OWNERS MAILING ADDRESS	TELEPHONE
(1)	<u>Scott Wischow</u>	<u>Wish Properties LLC</u> <u>550 Overhill Dr.</u>	<u>828-674-6565</u>
	<u>Scott Wischow</u>	<u>Hendersonville, NC</u>	<u>28792</u>
(2)	<u>Elaine V. Lewis</u>	<u>1560 Sandy Ln.</u>	<u>727-729-5493</u>
	<u>Thomas L. Hanna</u>	<u>Clearwater, FL</u>	<u>828-696-4374</u>
	<u>Elaine V. Lewis</u>	<u>33755</u>	
(3)	<u>Nancy Patterson</u>	<u>84 Streamside Dr</u>	<u>828-698-8244</u>
	<u>Nancy Patterson</u>	<u>Hendersonville NC</u>	<u>28719 828 551-6029</u>
(4)	<u>HIGH LIGHT ELECTRIC INC.</u>	<u>P.O. BOX 1240 ETOWAH NC</u>	
		<u>28729-1240</u>	<u>828-891-5256</u>
(5)	<u>Danna V. Karrer</u>	<u>81 Streamside Dr</u>	<u>828-694-0504</u>
	<u>Danna V. Karrer</u>	<u>Hendersonville, NC</u>	<u>28791</u>
(6)	<u>Ann L. Alexander</u>	<u>57 Streamside Dr.</u>	<u>828-692-3886</u>
	<u>Ann L. Alexander</u>	<u>Hendersonville, NC</u>	<u>28791</u>

**INSTRUCTIONS FOR COMPLETING PETITION:**

1. Complete Information Section
2. Identify Contact Person (This person serves as spokesperson for petitioner(s)).
3. Attach four (4) copies of recorded subdivision plat or property deeds, which refer to candidate road.
4. Adjoining property owners and/or the developer may submit a petition. Subdivision roads with prior NCDOT review and approval only require the developer's signature.
5. If submitted by the developer, encroachment agreements from all utilities located within the right of way shall be submitted with the petition for Road addition. However, construction plans may not be required at this time.
6. Submit to District Engineer's Office.

**FOR NCDOT USE ONLY:** Please check the appropriate block☐ Rural Road☐ Subdivision established prior to October 1, 1975☐ Subdivision established after October 1, 1975**REQUIREMENTS FOR ADDITION**

If this road meets the requirements necessary for addition, we agree to grant the Department of Transportation a right-of-way of the necessary width to construct the road to the minimum construction standards of the NCDOT. This right-of-way will extend the entire length of the road that is requested to be added to the state maintained system and will include the necessary areas outside of the right-of-way for cut and fill slopes and drainage. Also, we agree to dedicate additional right-of-way at intersections for sight distance and design purposes and to execute said right-of-way agreement forms that will be submitted to us by representatives of the NCDOT. The right-of-way shall be cleared at no expense to the NCDOT, which includes the removal of utilities, fences, other obstructions, etc.

General Statute 136-102.6 (see page 29 for Statute) states that any subdivision recorded on or after October 1, 1975, must be built in accordance with NCDOT standards in order to be eligible for addition to the State Road System.

ROAD NAMELENGTHROAD NAMELENGTH

# STATE ROAD PETITION REQUEST

STREAMSIDE DR

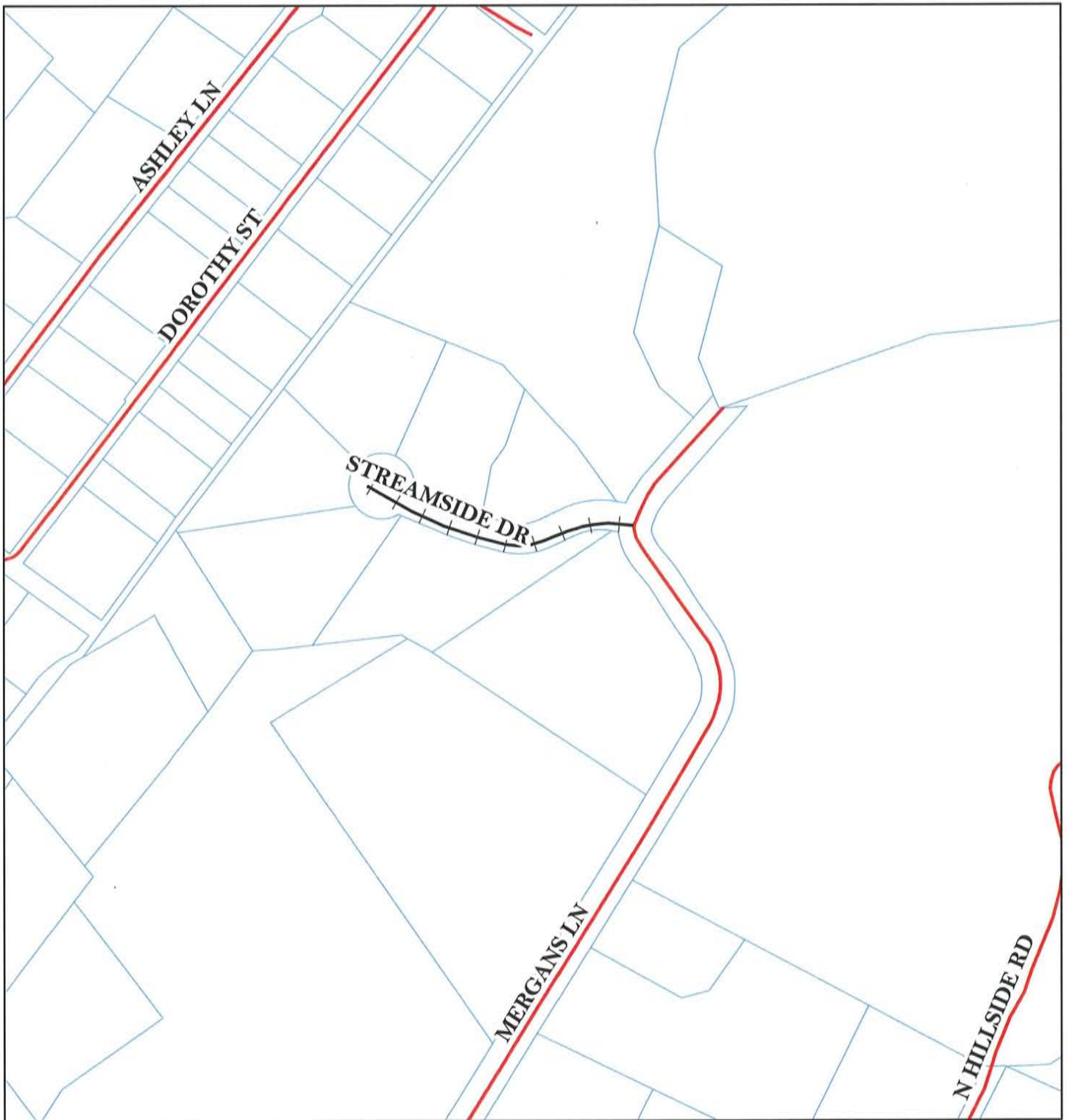

## Legend

- COLLECTOR
- LOCAL ROAD
- Proposed addition to state maintenance



North Carolina Department of Transportation  
Division of Highways  
Petition for Road Addition

OCT 31 2008

**ROADWAY INFORMATION:** (Please Print/Type)

County: Henderson Road Name: Roasted Chestnut Trial (Pre 911 re-addressing Chestnut Court)

(Please list additional street names and lengths on the back of this form.)

Subdivision Name: Chestnut Ridge Length (miles): .117

Number of occupied homes having street frontage: 8. Location 0

miles 0 miles N ☐ S ☐ E ☒ W ☐ of the intersection of Route 1964 and Route 0  
(Check one) (SR, NC, US) (SR, NC, US)

We, the undersigned, being property owners and/or developers of Chestnut Ridge in Henderson County, do hereby request the Division of Highways to add the above described road.

**CONTACT PERSON:** Name and Address of First Petitioner. (Please Print/Type)

Name: Flaughn Lamb (developer) Phone Number: 828-685-1006

Street Address: 3389 Sugarloaf Road

Mailing Address: Hendersonville, NC 28792

**PROPERTY OWNERS**

Name

Mailing Address

Telephone

(Developer)

3389 Sugarloaf Road

828-685-1006

<u>ROAD NAME</u>	<u>HOMES</u>	<u>LENGTH</u>	<u>ROAD NAME</u>	<u>HOMES</u>	<u>LENGTH</u>
Roasted Chestnut Tr.	8	.117 miles			

**INSTRUCTIONS FOR COMPLETING PETITION:**

1. Complete Information Section
2. Identify Contact Person (This person serves as spokesperson for petitioner(s)).
3. Attach four (4) copies of recorded subdivision plat or property deeds, which refer to candidate road.
4. Adjoining property owners and/or the developer may submit a petition. Subdivision roads with prior NCDOT review and approval only require the developer's signature.
5. If submitted by the developer, encroachment agreements from all utilities located within the right of way shall be submitted with the petition for Road addition. However, construction plans may not be required at this time.
6. Submit to District Engineer's Office.

**FOR NCDOT USE ONLY:** Please check the appropriate block

☐ Rural Road    ☐ Subdivision platted prior to October 1, 1975    ☐ Subdivision platted after October 1, 1975

**REQUIREMENTS FOR ADDITION**

If this road meets the requirements necessary for addition, we agree to grant the Department of Transportation a right-of-way of the necessary width to construct the road to the minimum construction standards of the NCDOT. The right-of-way will extend the entire length of the road that is requested to be added to the state maintained system and will include the necessary areas outside of the right-of-way for cut and fill slopes and drainage. Also, we agree to dedicate additional right-of-way at intersections for sight distance and design purposes and execute said right-of-way agreement forms that will be submitted to us by representatives of the NCDOT. The right-of-way shall be cleared at no expense to the NCDOT, which includes the removal of utilities, fences, other obstructions, etc.

General Statute 136-102.6 (see page 29 for Statute) states that any subdivision recorded on or after October 1, 1975, must be built in accordance with NCDOT standards in order to be eligible for addition to the State Road System.



# STATE ROAD PETITION REQUEST

ROASTED CHESTNUT TRL

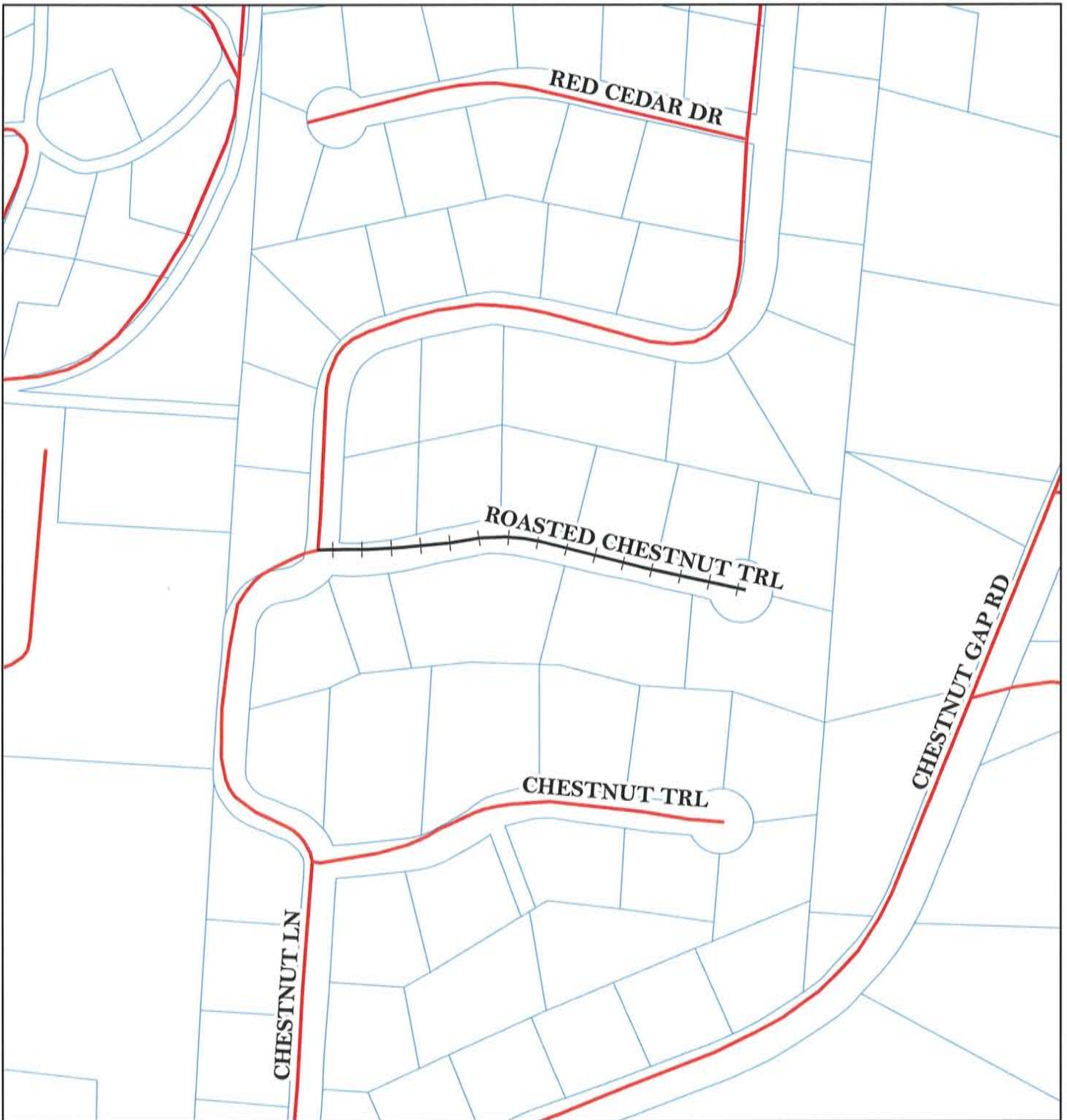

## Legend

- COLLECTOR
- LOCAL ROAD
- Proposed addition to state maintenance

